



Engineering • Design • Consulting

February 5, 2020

ADDENDUM NO. 02

PROJECT: South Ridge Community Park – Enhancement Plan 2019
1450 Freeman Road
Hoffman Estates, IL
W-T Project #1911354C

TO: All Plan Holders

This addendum shall be included in and become part of the Contract Documents. The above named Project Specifications and Drawings previously issued are hereby modified as follows:

General Clarifications

1. The aggregate base course underneath the synthetic turf areas shall consist of 6" minimum of Vulcan 210 stone. Details on Sheets C-4.6 and C-4.7 have been revised accordingly.

Plans

General: Revisions have been clouded and labeled as ADD#2 on the following plan sheets:

1. Sheet C-4.6 – Site Development Details

- a. Detail – UNDERDRAIN BELOW SYNTHETIC TURF PLAYGROUND AND FITNESS AREA: Aggregate base changed to 6" min of Vulcan 210 stone.
- b. Detail – PLAYGROUND CLEAN OUT (WITHIN PLAYGROUND): Gravel backfill changed to Vulcan 210 stone.

2. Sheet C-4.7 – Site Development Details

- a. Detail – SYNTHETIC TURF ADJACENT TO PLAYGROUND CURB: Aggregate base changed to 6" min. of Vulcan 210 stone. Aggregate thickness underneath playground curb shall be 4" minimum CA-6 granular base.
- b. Detail – SYNTHETIC TURF ADJACENT TO MONOLITHIC PLAYGROUND SIDEWALK: Aggregate base changed to 6" min. of Vulcan 210 stone.

- c. Detail – PLAYGROUND TRANSITION CURB: Aggregate base changed to 6" min. of Vulcan 210 stone. Aggregate thickness underneath transition curb shall be 4" minimum CA-6 granular base.

END OF ADDENDUM NO. 2

Respectfully Submitted,

The W-T Group, LLC

A handwritten signature in black ink, appearing to read 'Todd Abrams', is written over a light blue rectangular background.

Todd Abrams, P.E., CFM
Principal in Charge, Civil Engineering Department
(224) 293-6391

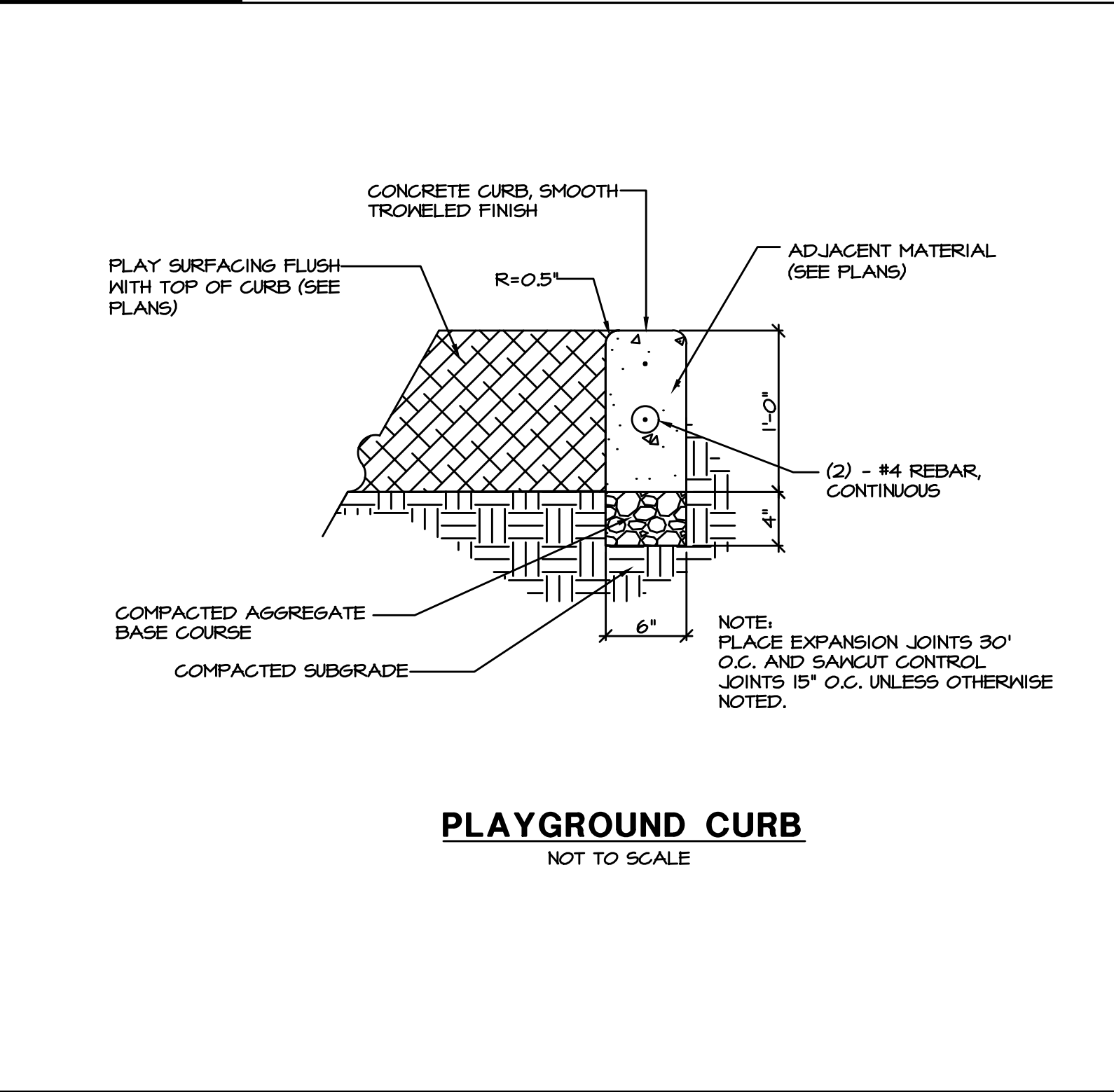
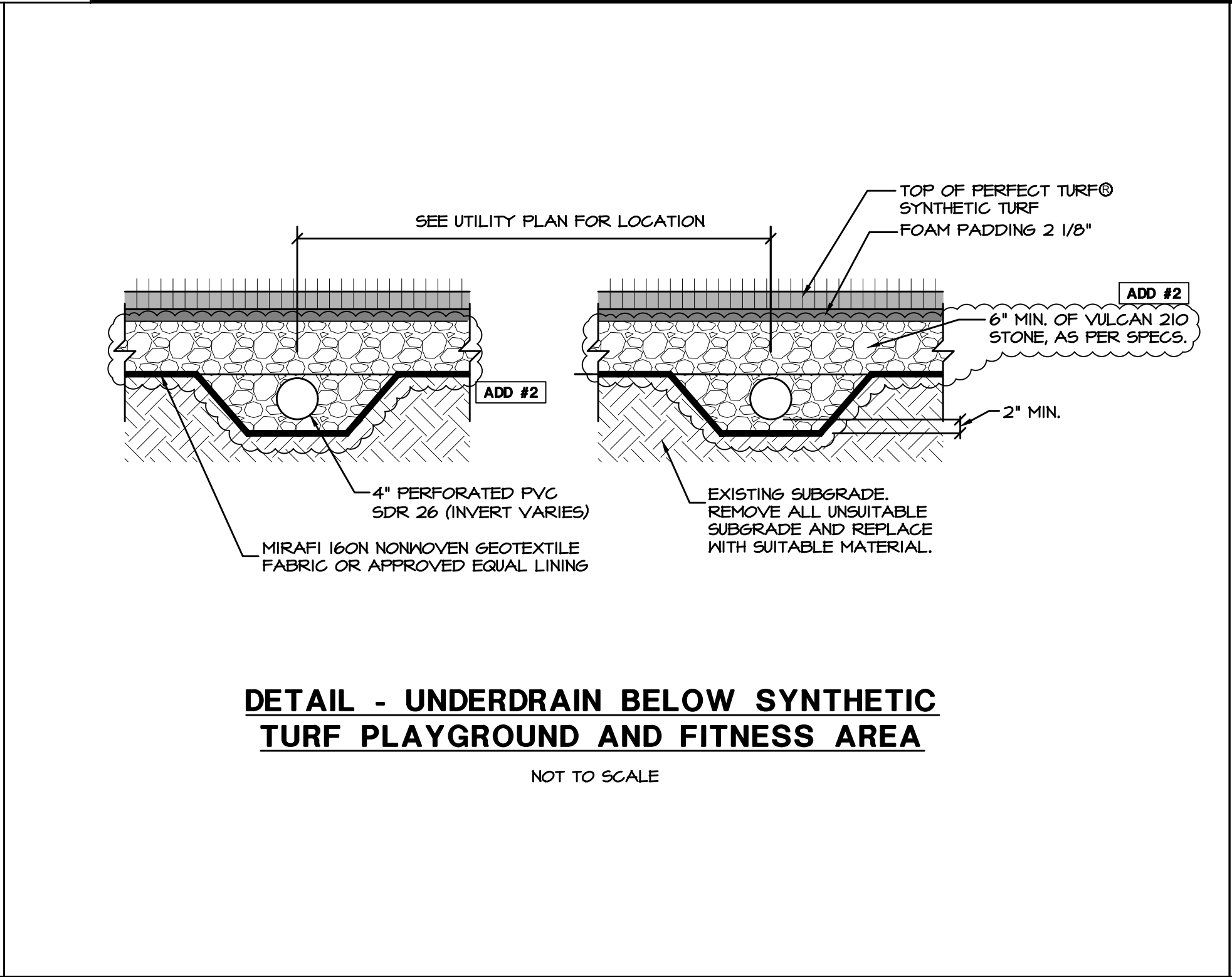
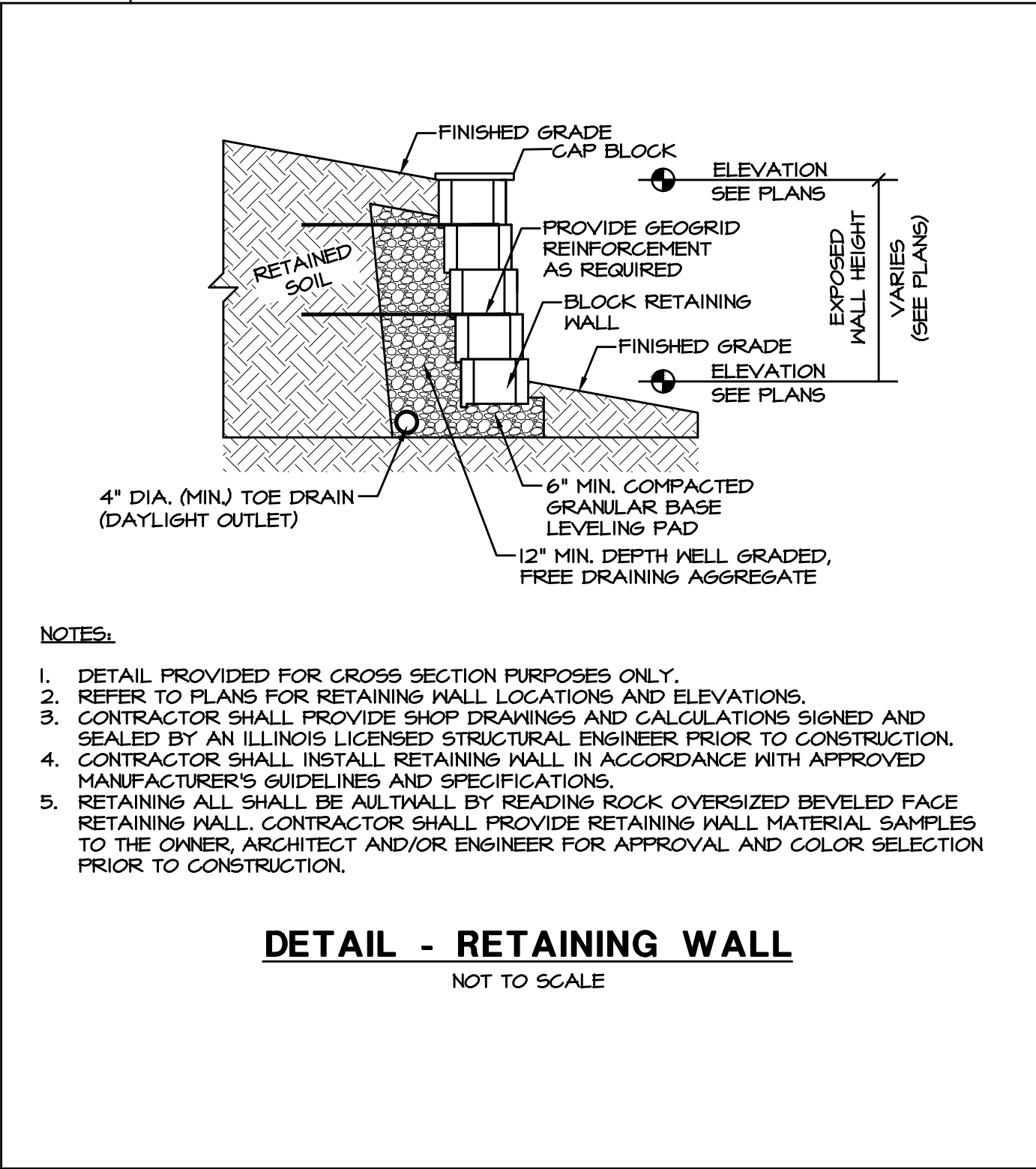
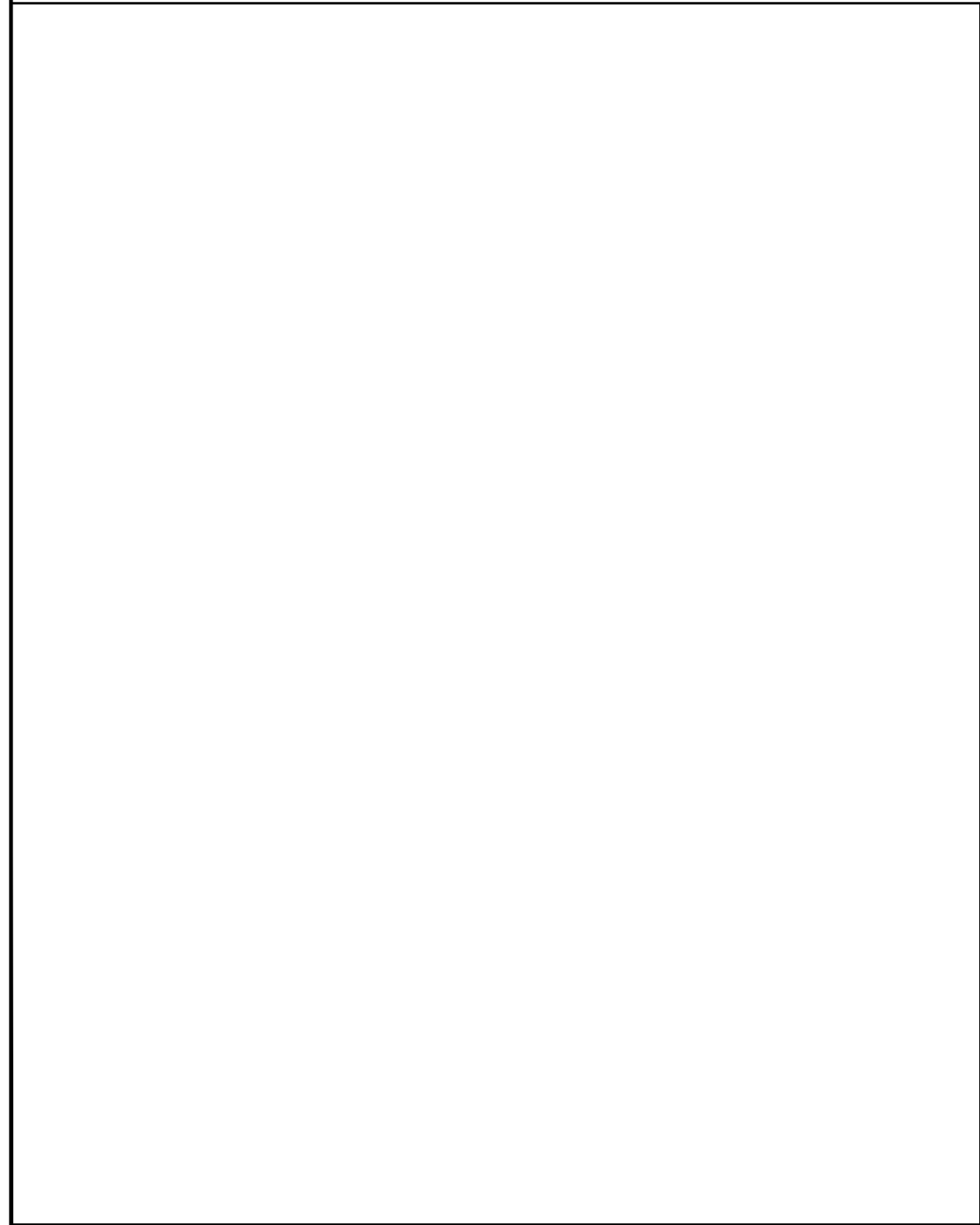
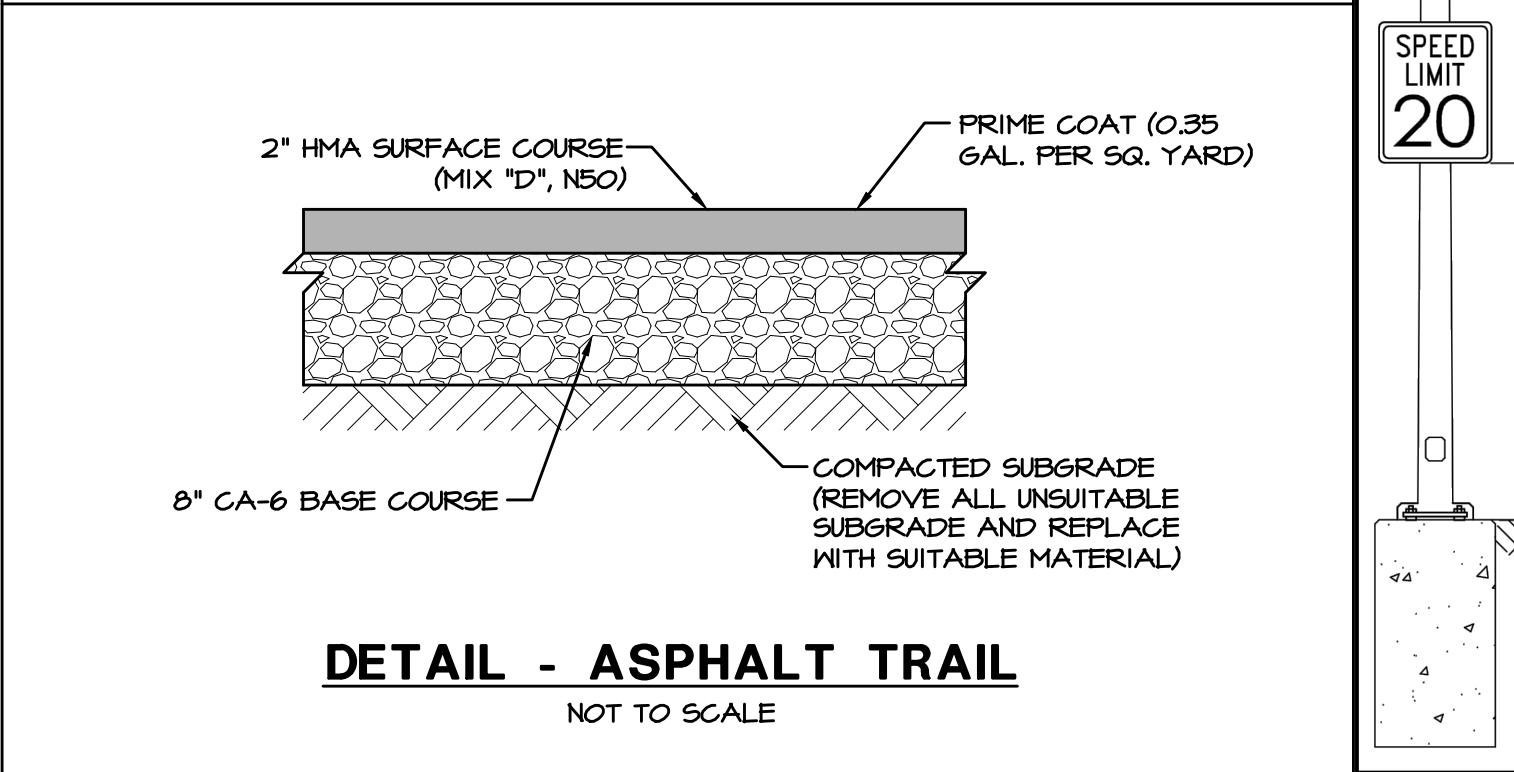
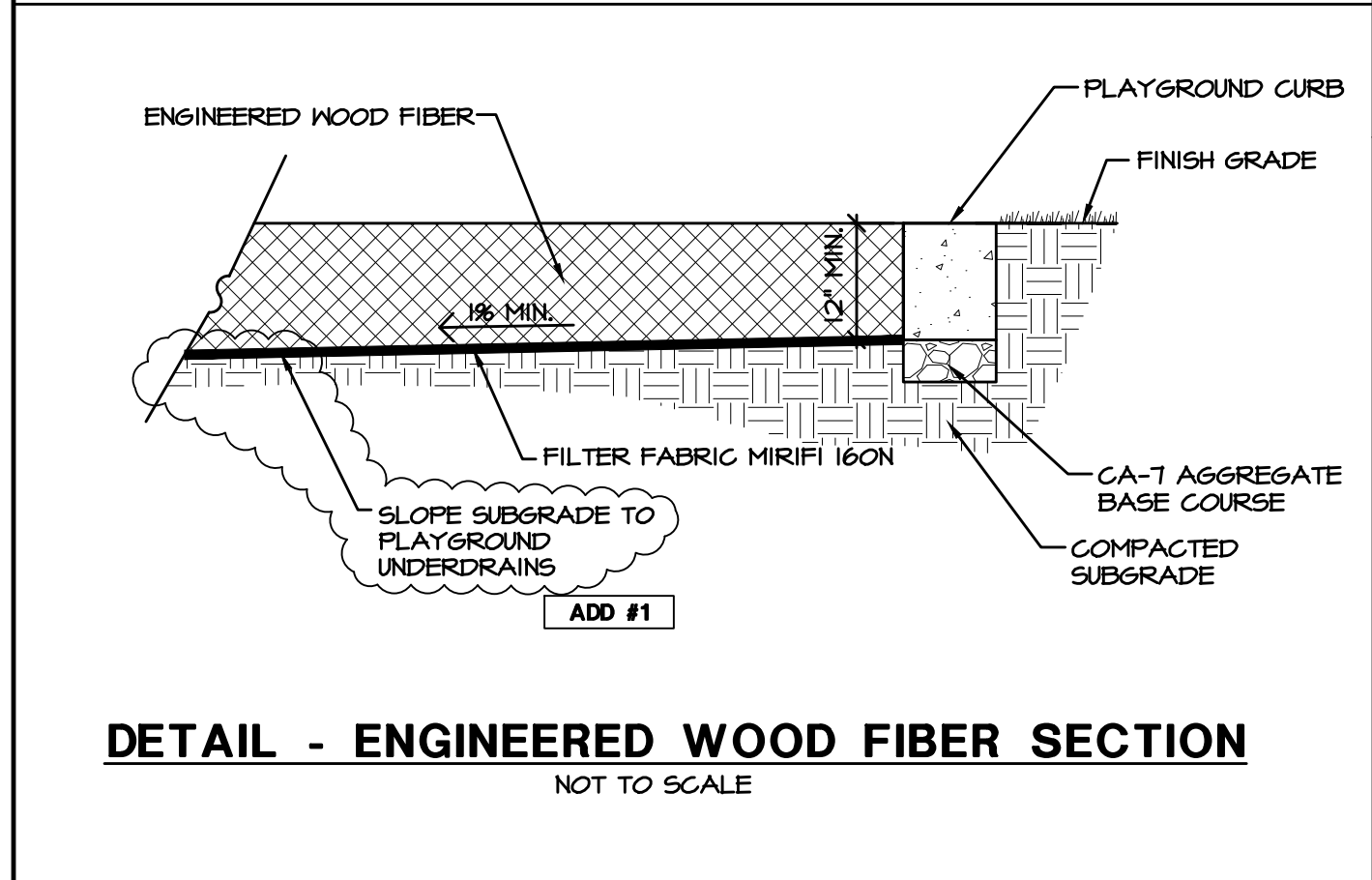
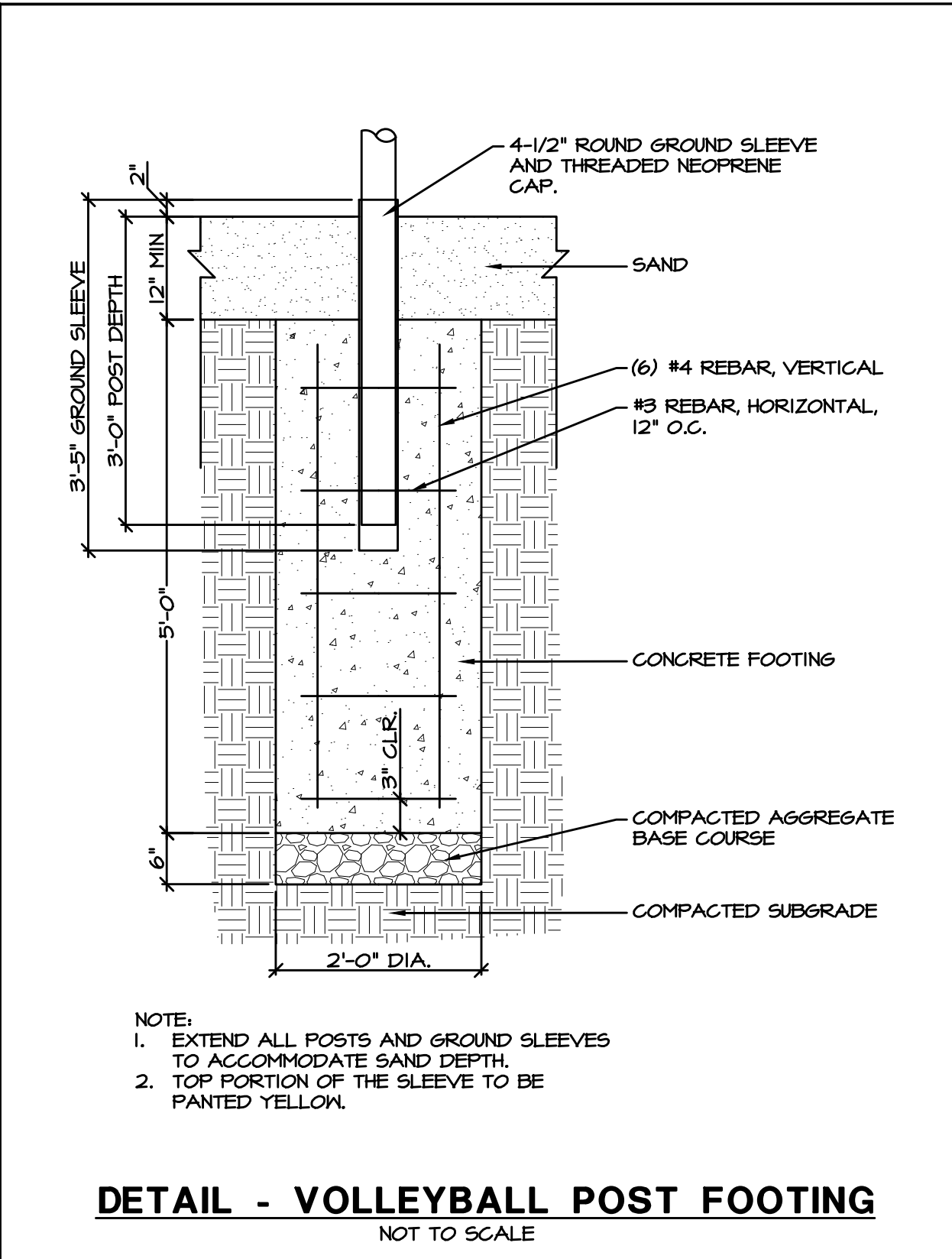
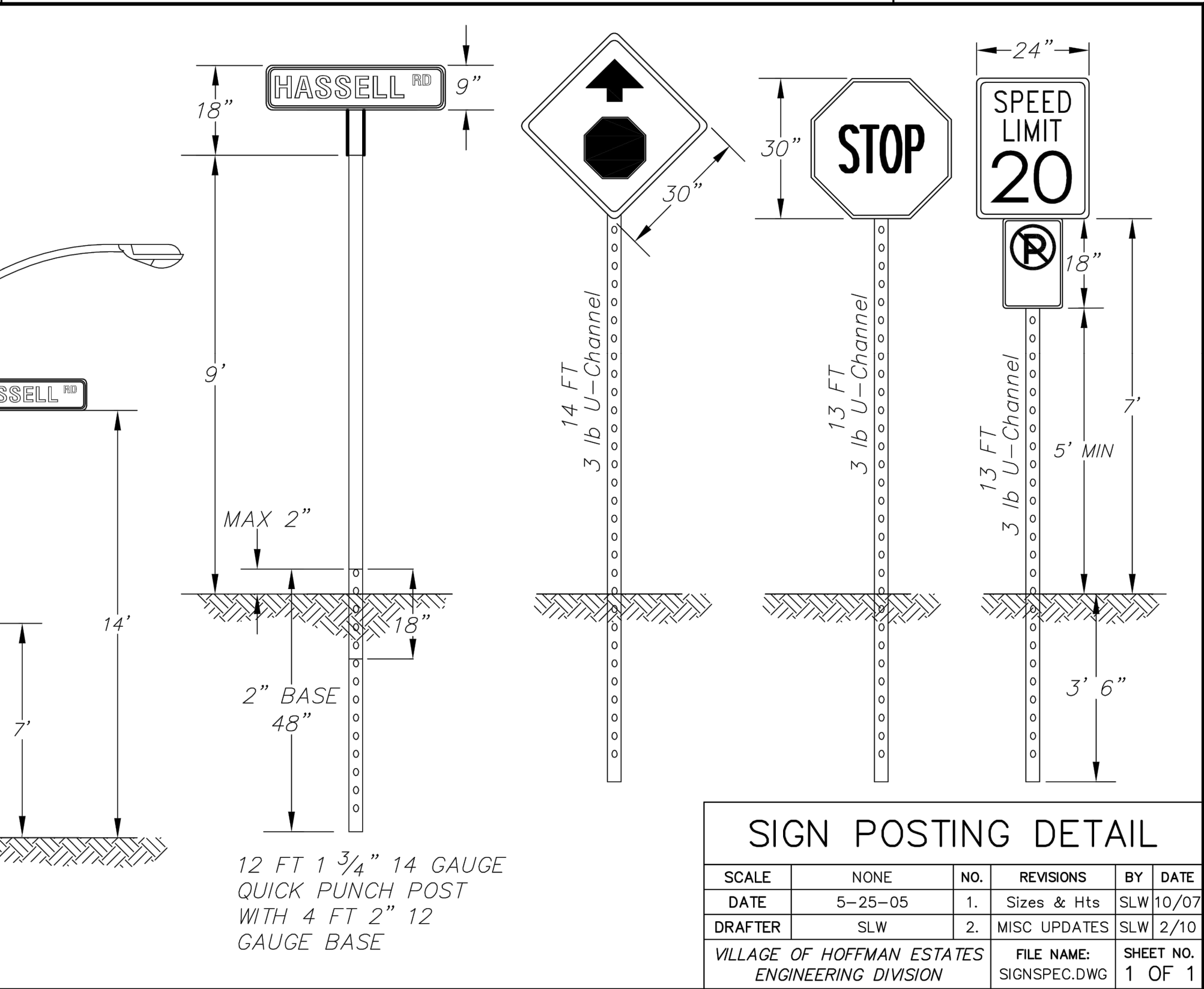
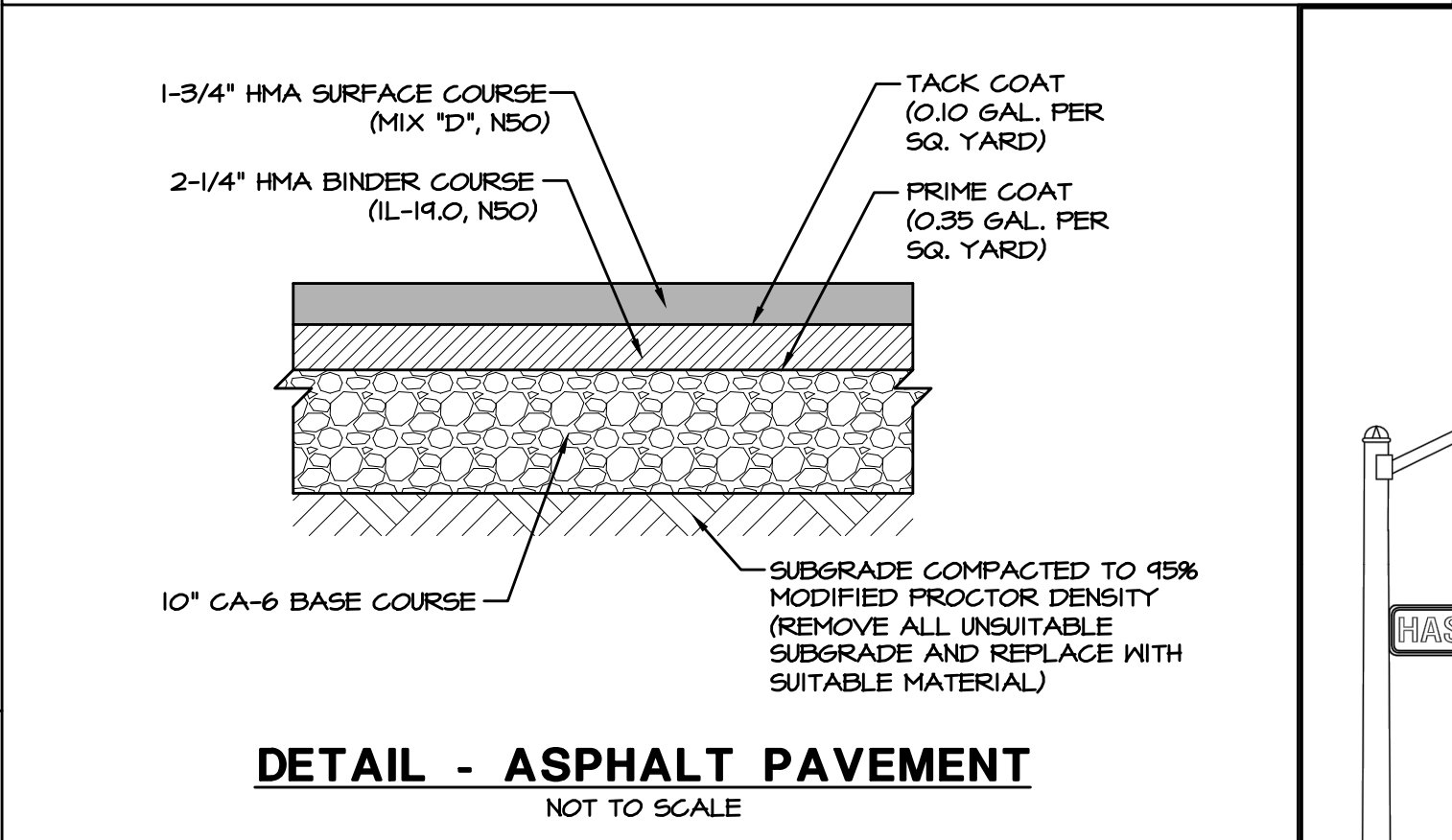
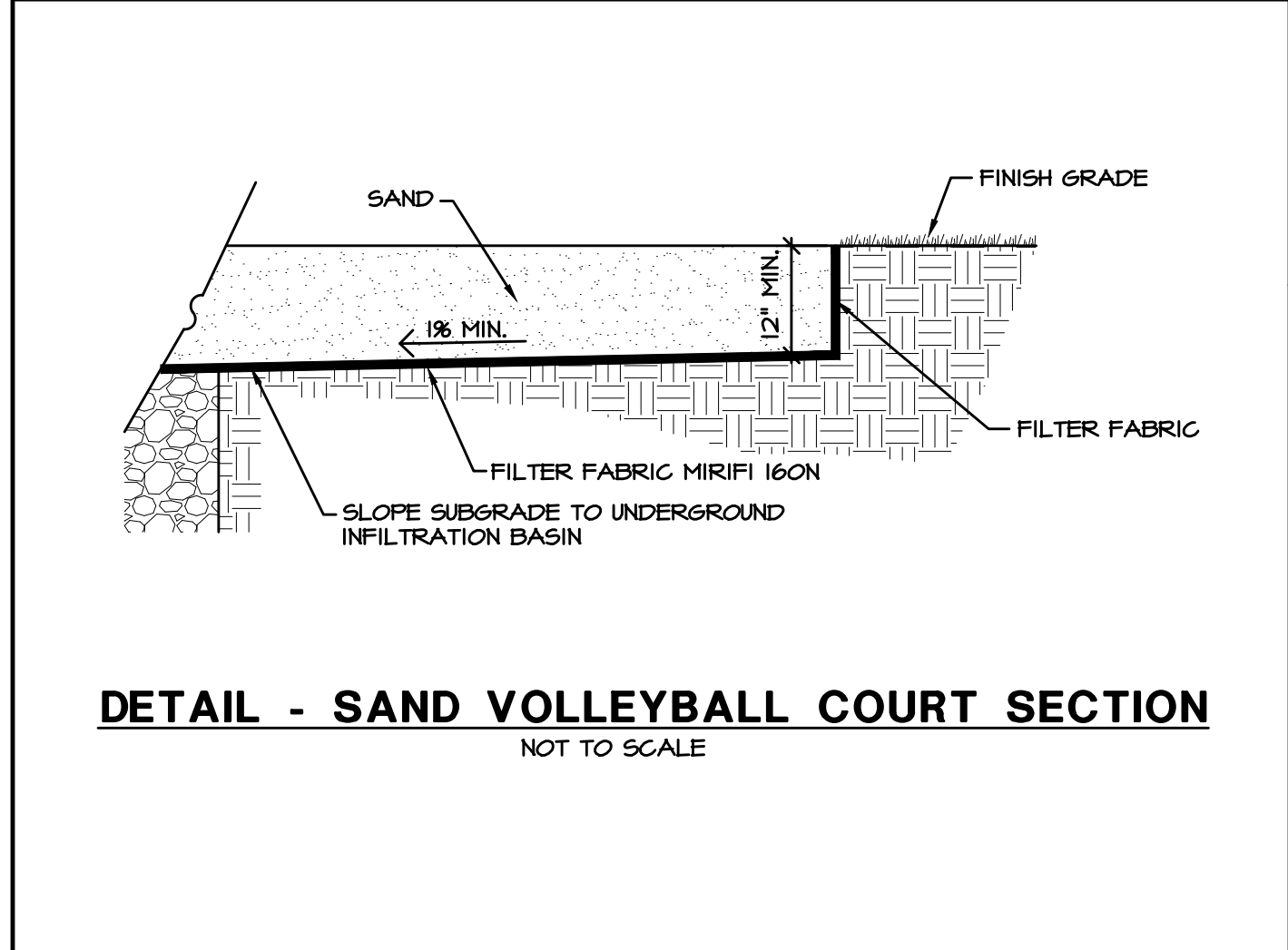
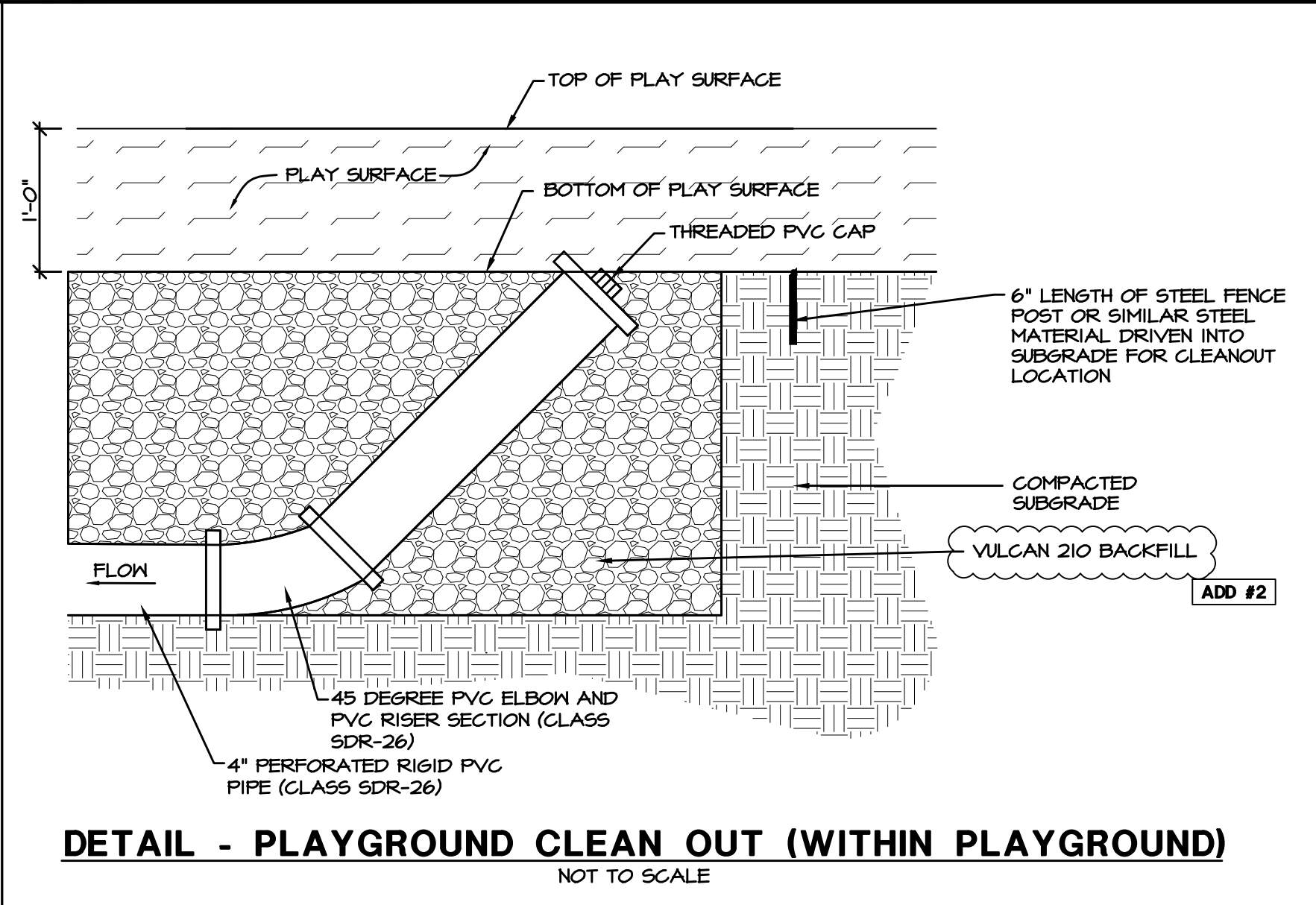
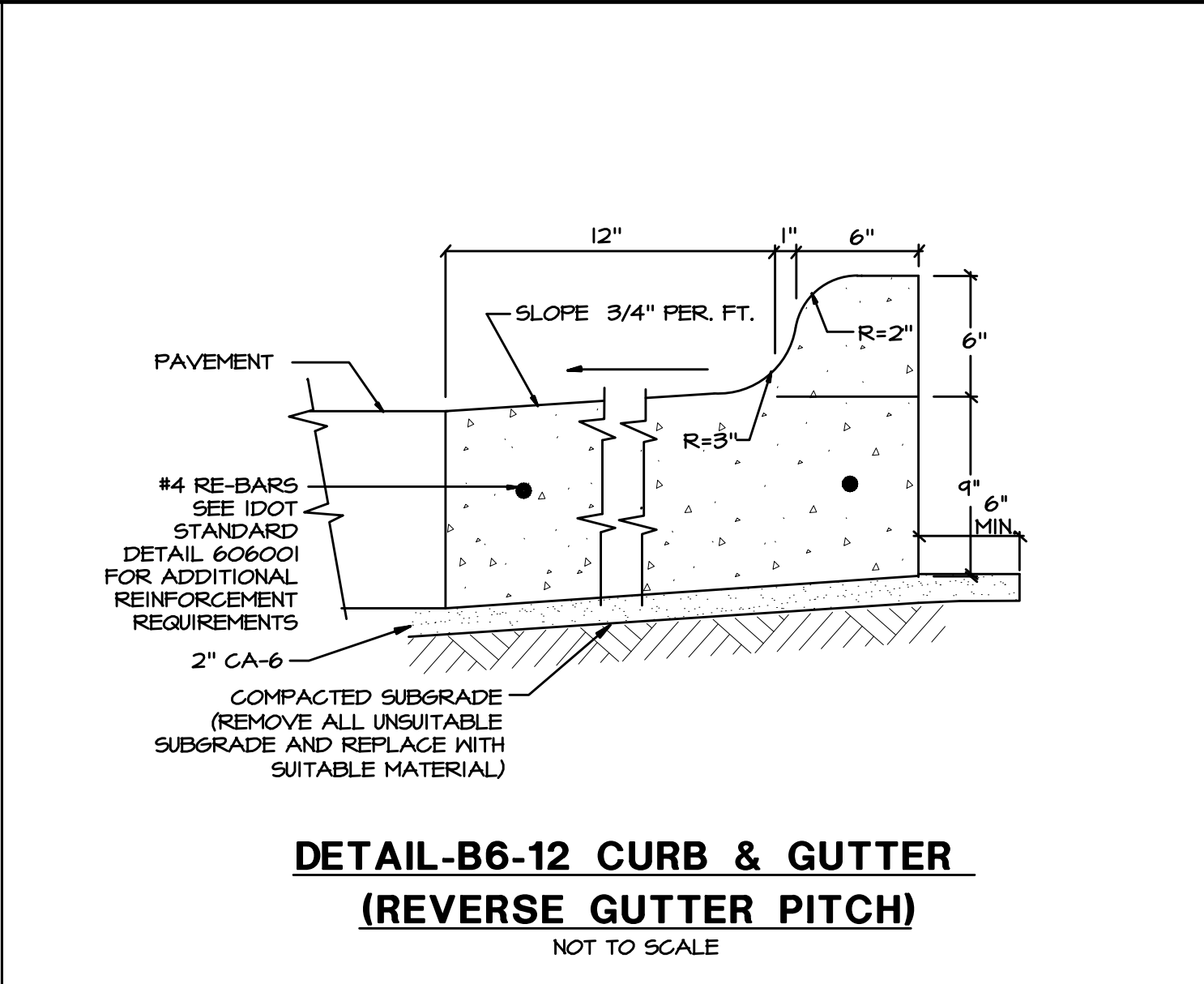
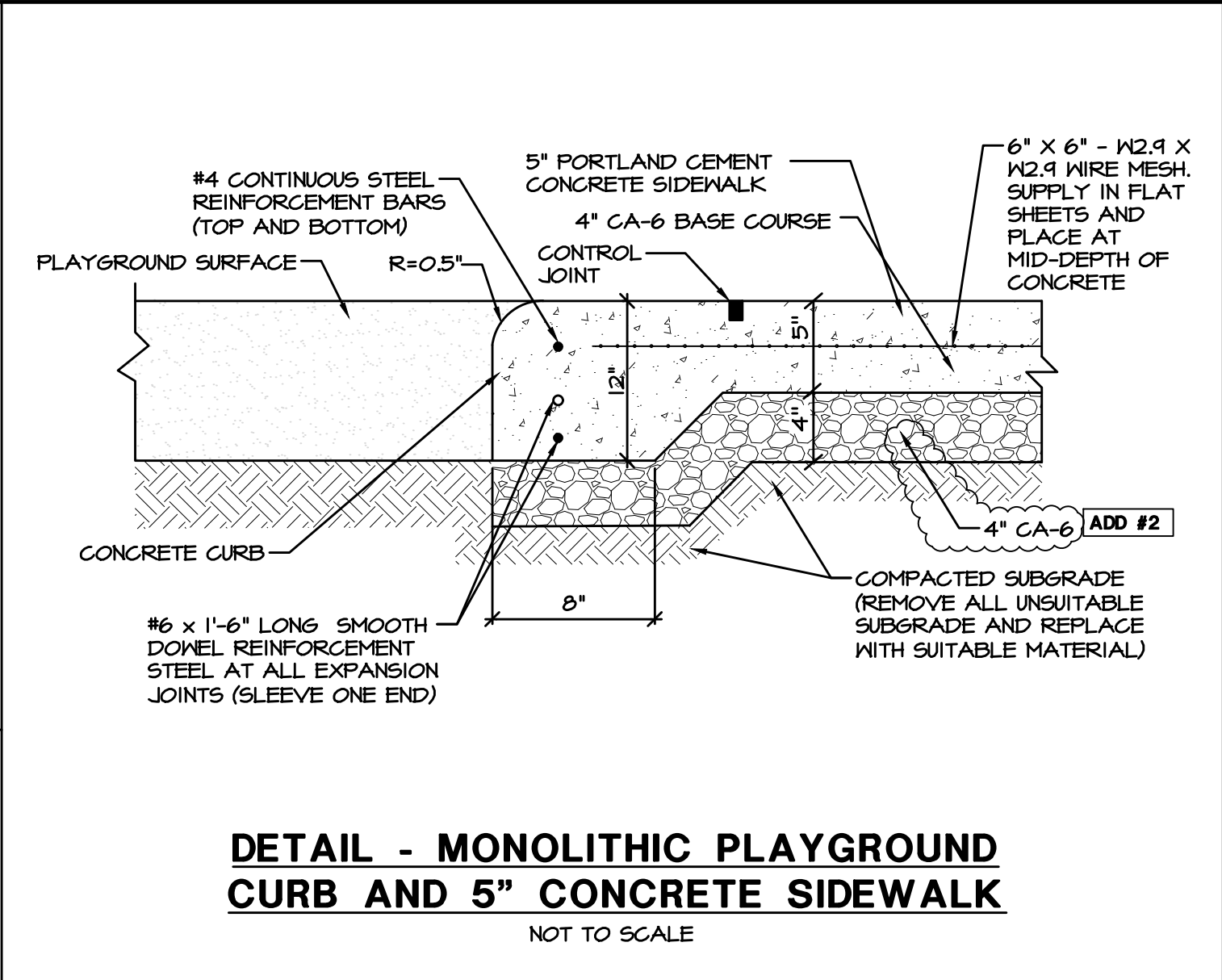
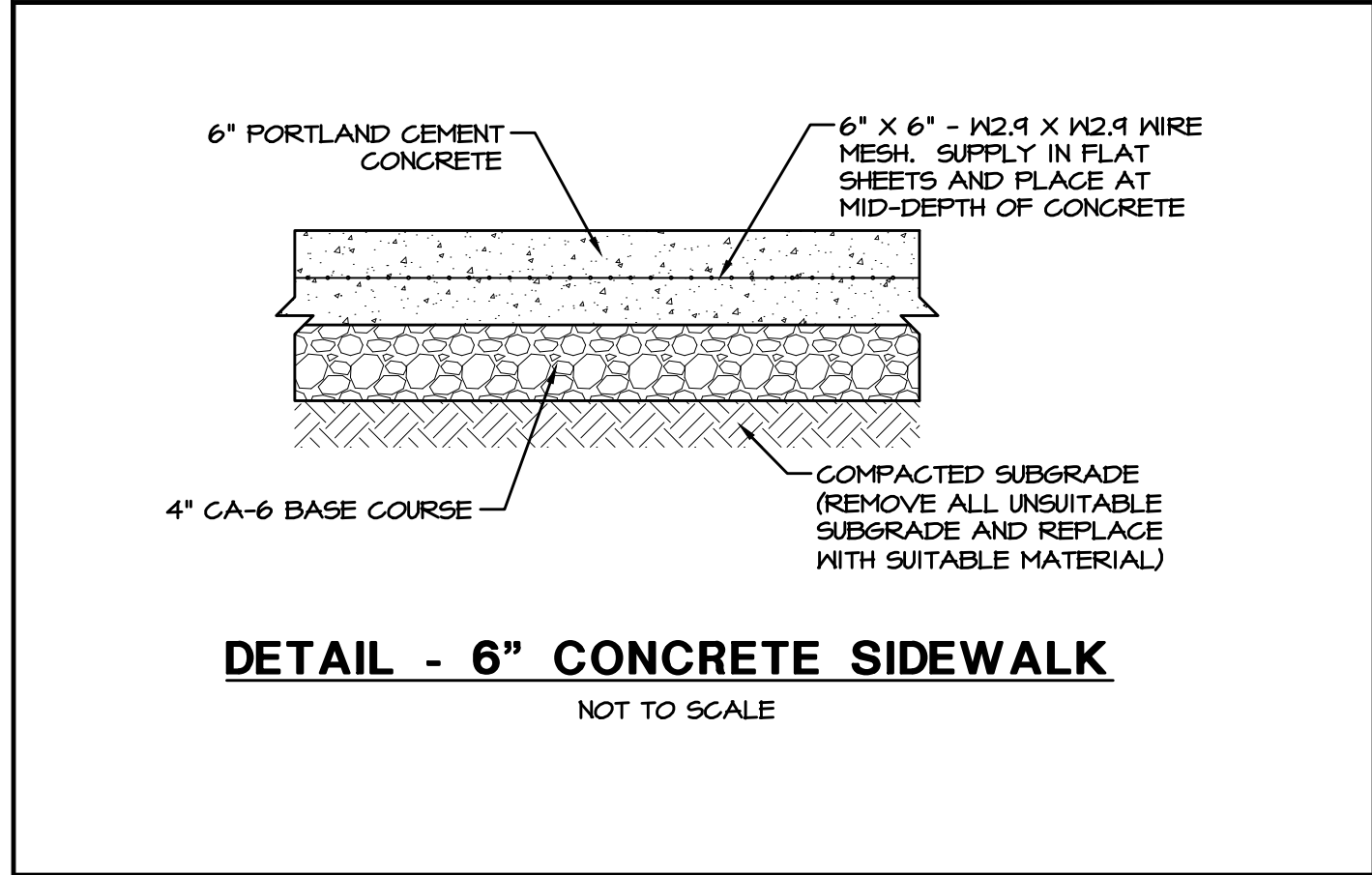

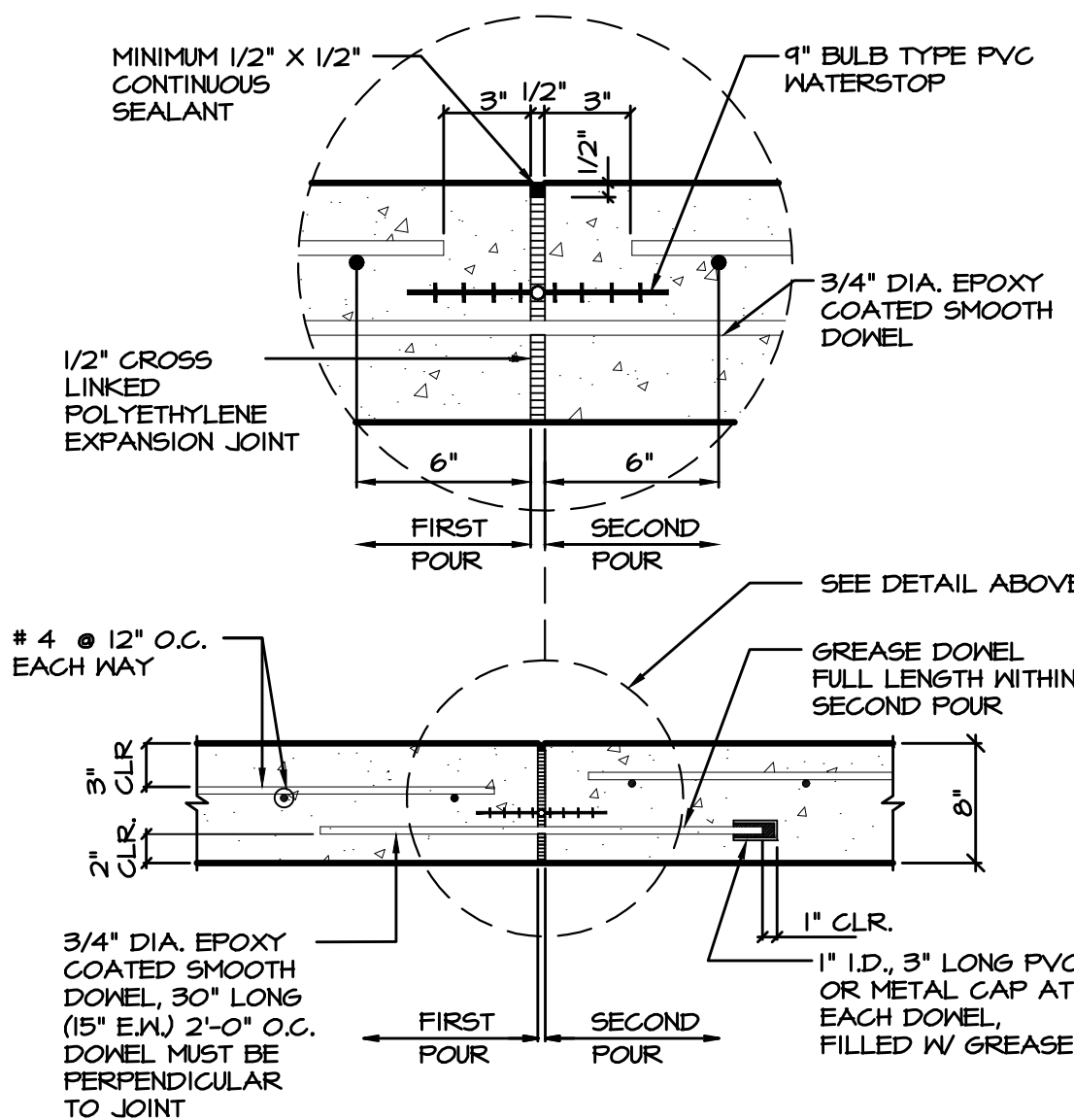

DETAIL - SPLASH PAD EXPANSION JOINT DETAIL
NOT TO SCALE

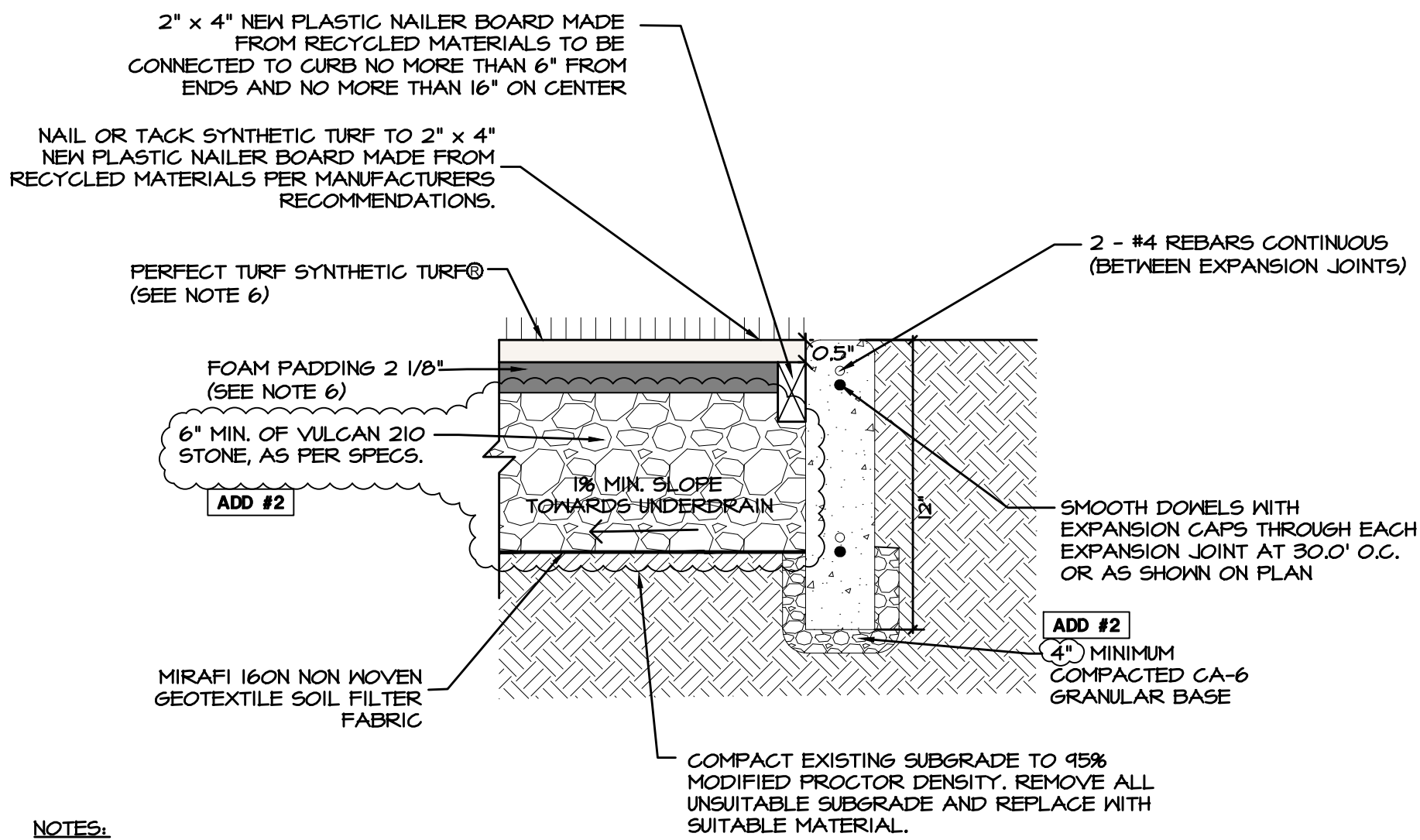

- NOTES:
- 1" THICK PREFORMED EXPANSION JOINTS SHALL BE INSTALLED AT A MINIMUM OF 50 FOOT INTERVALS AND AT ALL CURB P.C.'S AND P.T.'S, CURB RETURNS, ENDS OF CONSTRUCTION AND FIVE (5) FEET ON EACH SIDE OF ANY UTILITY STRUCTURE CASTING THAT FALLS WITHIN THE CURB LINE. PROVIDE 1-1/2" x 18" SMOOTH EPOXY COATED DOWEL BARS AT EXPANSION JOINTS WITH DOWEL BAR AND PINCH CAP.
 - EXPANSION JOINTS SHALL BE INSTALLED ON ALL RADIUS POINTS AND AT A DISTANCE OF 5 FEET ON EACH SIDE OF A UTILITY STRUCTURE CASTING THAT FALLS WITHIN THE CURB LINE. MAXIMUM SPACING = 50 FEET.
 - CONTROL JOINTS SHALL BE SAWED TO A MINIMUM DEPTH OF 2" AND PLACED AT 10 FOOT INTERVALS. SAW CUTS SHALL BE SAWED NO SOONER THAN 6 HOURS AND NO LATER THAN 24 HOURS AFTER PLACEMENT OF CONCRETE.
 - 2 CONTINUOUS NO. 4 BARS SHALL BE INSTALLED AND CENTERED OVER ALL TRENCH CROSSINGS SO BARS EXTEND 5 FEET BEYOND THE TRENCH ON ALL SIDES.
 - DOWEL BARS AT EXPANSION JOINTS MUST BE DRILLED AND NOT PUSHED THRU EXPANSION MATERIAL.
 - SYNTHETIC TURF MAT, FOAM PADDING, AND RUBBER INFILL SHALL BE PROVIDED BY THE OWNER FOR THE FITNESS AREA.

DETAIL - SYNTHETIC TURF ADJACENT
TO PLAYGROUND CURB
NOT TO SCALE

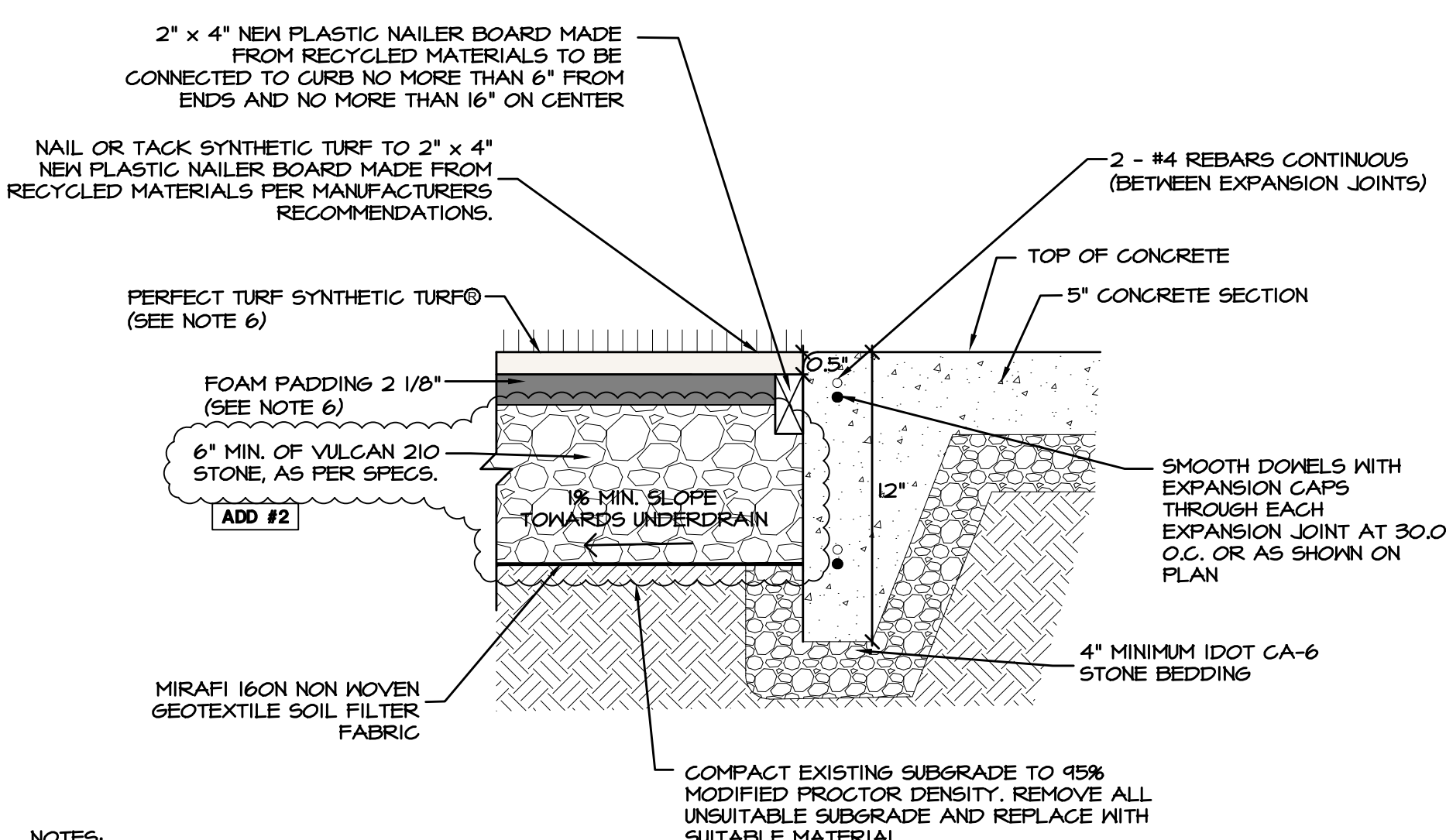

- NOTES:
- 1" THICK PREFORMED EXPANSION JOINTS SHALL BE INSTALLED AT A MINIMUM OF 50 FOOT INTERVALS AND AT ALL CURB P.C.'S AND P.T.'S, CURB RETURNS, ENDS OF CONSTRUCTION AND FIVE (5) FEET ON EACH SIDE OF ANY UTILITY STRUCTURE CASTING THAT FALLS WITHIN THE CURB LINE. PROVIDE 1-1/2" x 18" SMOOTH EPOXY COATED DOWEL BARS AT EXPANSION JOINTS WITH DOWEL BAR AND PINCH CAP.
 - EXPANSION JOINTS SHALL BE INSTALLED ON ALL RADIUS POINTS AND AT A DISTANCE OF 5 FEET ON EACH SIDE OF A UTILITY STRUCTURE CASTING THAT FALLS WITHIN THE CURB LINE. MAXIMUM SPACING = 50 FEET.
 - CONTROL JOINTS SHALL BE SAWED TO A MINIMUM DEPTH OF 2" AND PLACED AT 10 FOOT INTERVALS. SAW CUTS SHALL BE SAWED NO SOONER THAN 6 HOURS AND NO LATER THAN 24 HOURS AFTER PLACEMENT OF CONCRETE.
 - 2 CONTINUOUS NO. 4 BARS SHALL BE INSTALLED AND CENTERED OVER ALL TRENCH CROSSINGS SO BARS EXTEND 5 FEET BEYOND THE TRENCH ON ALL SIDES.
 - DOWEL BARS AT EXPANSION JOINTS MUST BE DRILLED AND NOT PUSHED THRU EXPANSION MATERIAL.
 - SYNTHETIC TURF MAT, FOAM PADDING, AND RUBBER INFILL SHALL BE PROVIDED BY THE OWNER FOR THE FITNESS AREA.

DETAIL - SYNTHETIC TURF ADJACENT
TO MONOLITHIC PLAYGROUND SIDEWALK
NOT TO SCALE

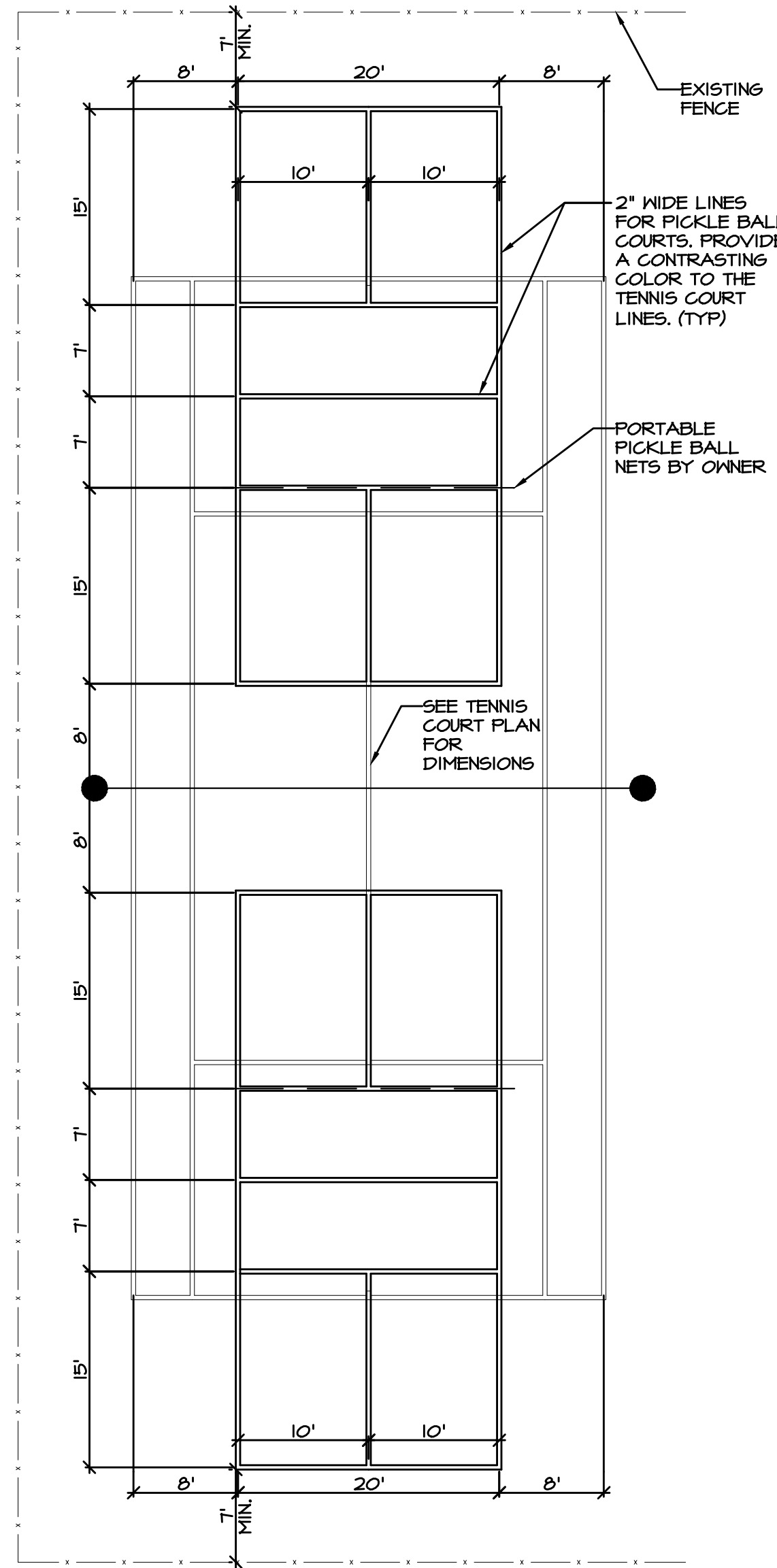

DETAIL - PICKLE BALL COURT PLAN
1" = 10'

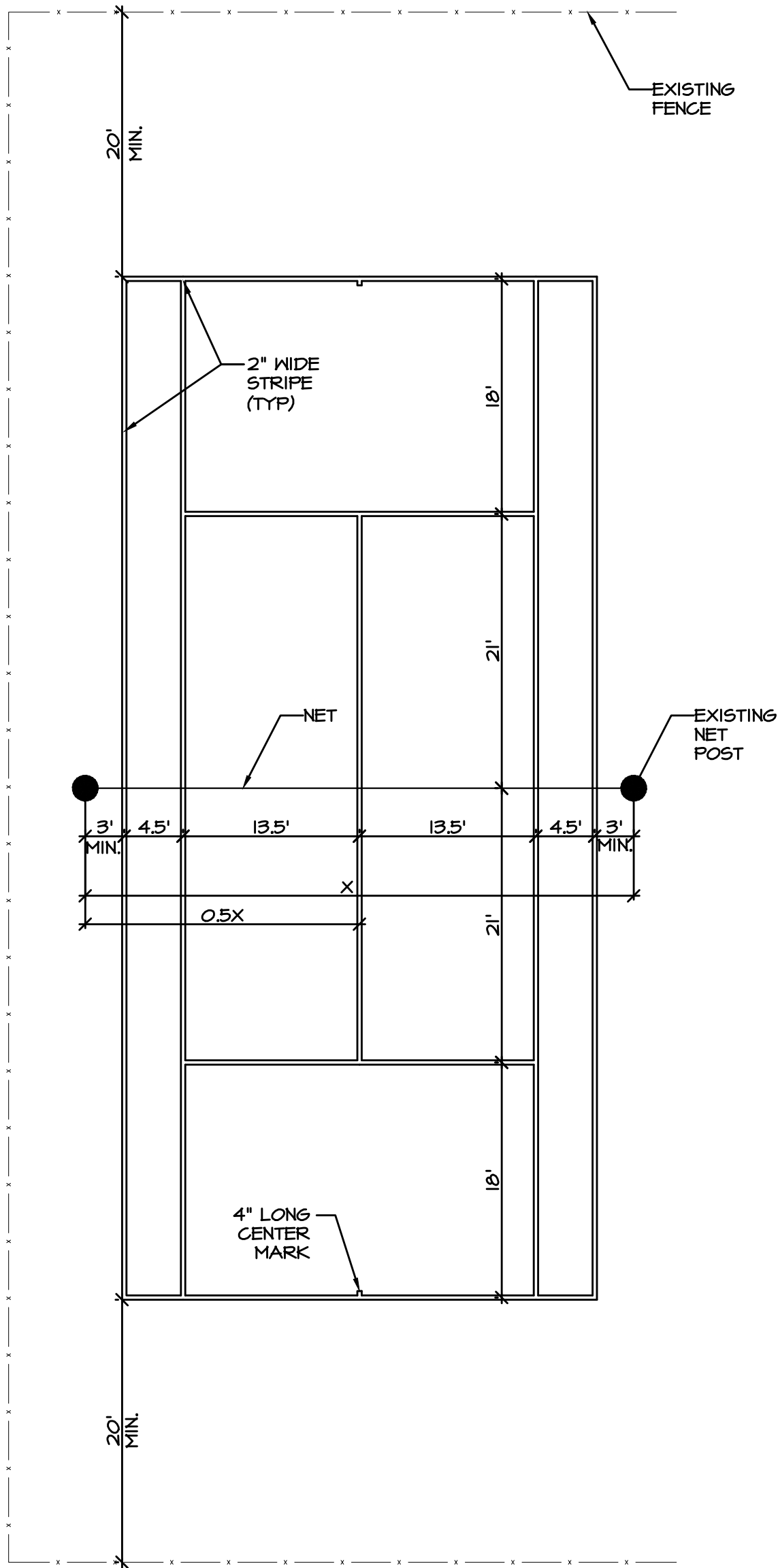

DETAIL - TENNIS COURT PLAN
1" = 10'

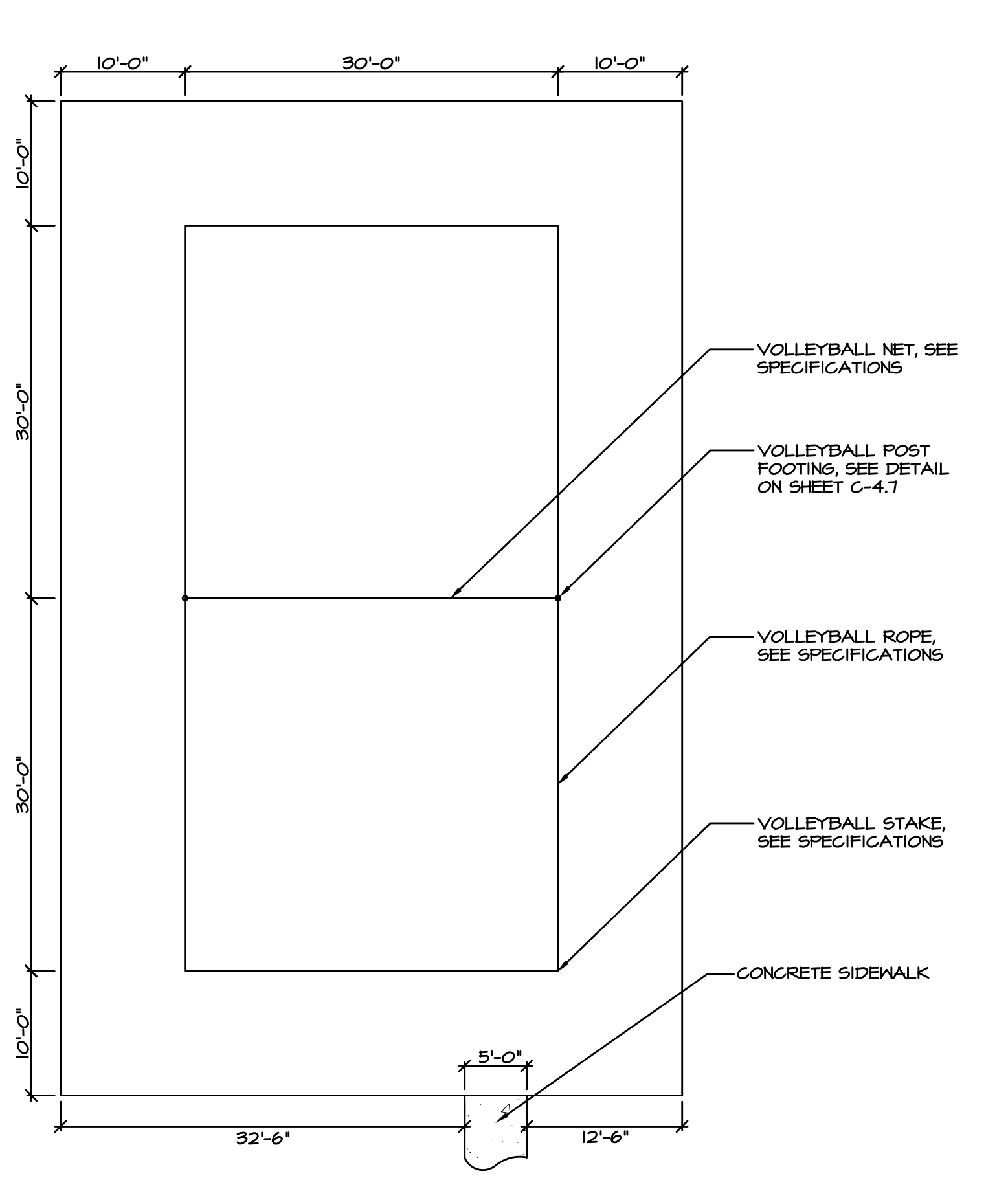

DETAIL - VOLLEYBALL COURT PLAN
1" = 10'

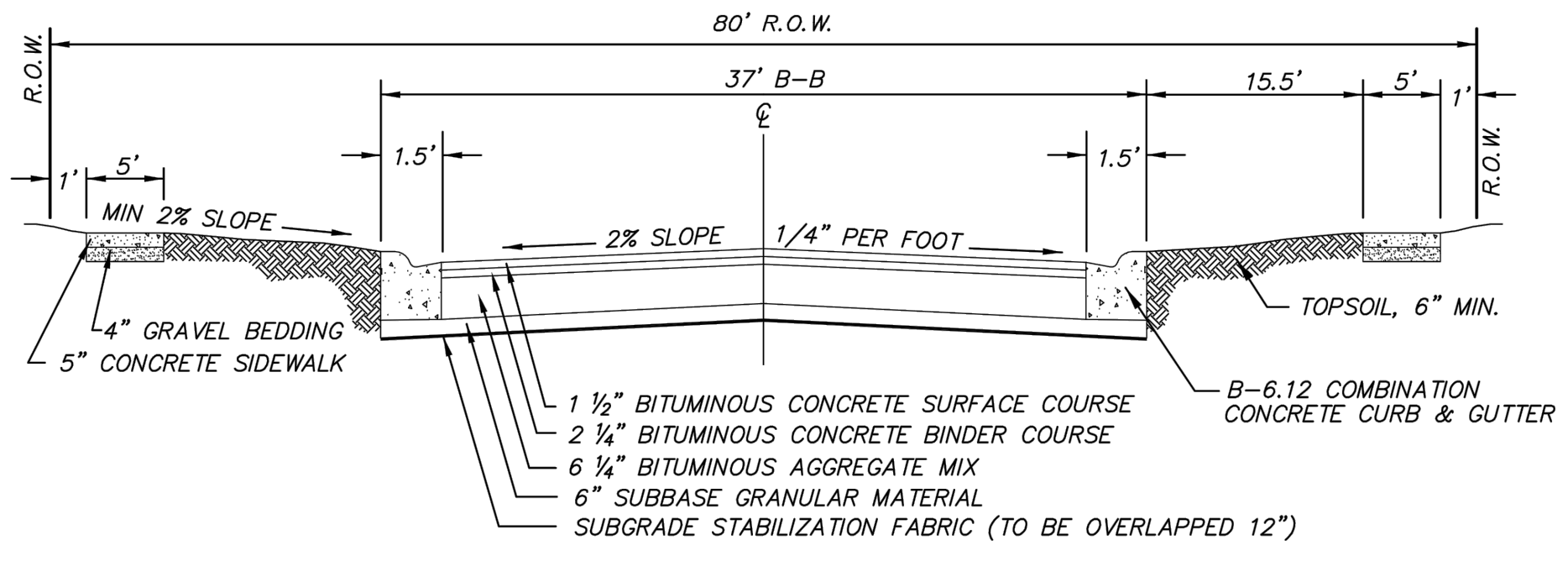

NOTE: PRIOR TO PLACEMENT OF STABILIZATION FABRIC, SUBGRADE IS TO BE PROOFROLLED WITH THE VILLAGE ENGINEER PRESENT. PAVEMENT MARKINGS TO BE 3M™ STAMARK™ TAPES. CHECK WITH THE VILLAGE ENGINEER FOR CURRENT MIX DESIGNS.

| CROSS SECTION FOR ≥ 80 FOOT ROW | | | |
|---------------------------------------|------------|------------------|---------|
| SCALE | NONE | NO. REVISIONS | BY DATE |
| DATE | 5-25-05 | 1. MISC. UPDATES | SW 2/10 |
| DRAFTER | SLW | | |
| VILLAGE OF HOFFMAN ESTATES | FILE NAME: | SHEET NO. | |
| TRANSPORTATION & ENGINEERING DIVISION | ROAD80.DWG | 1 OF 1 | |

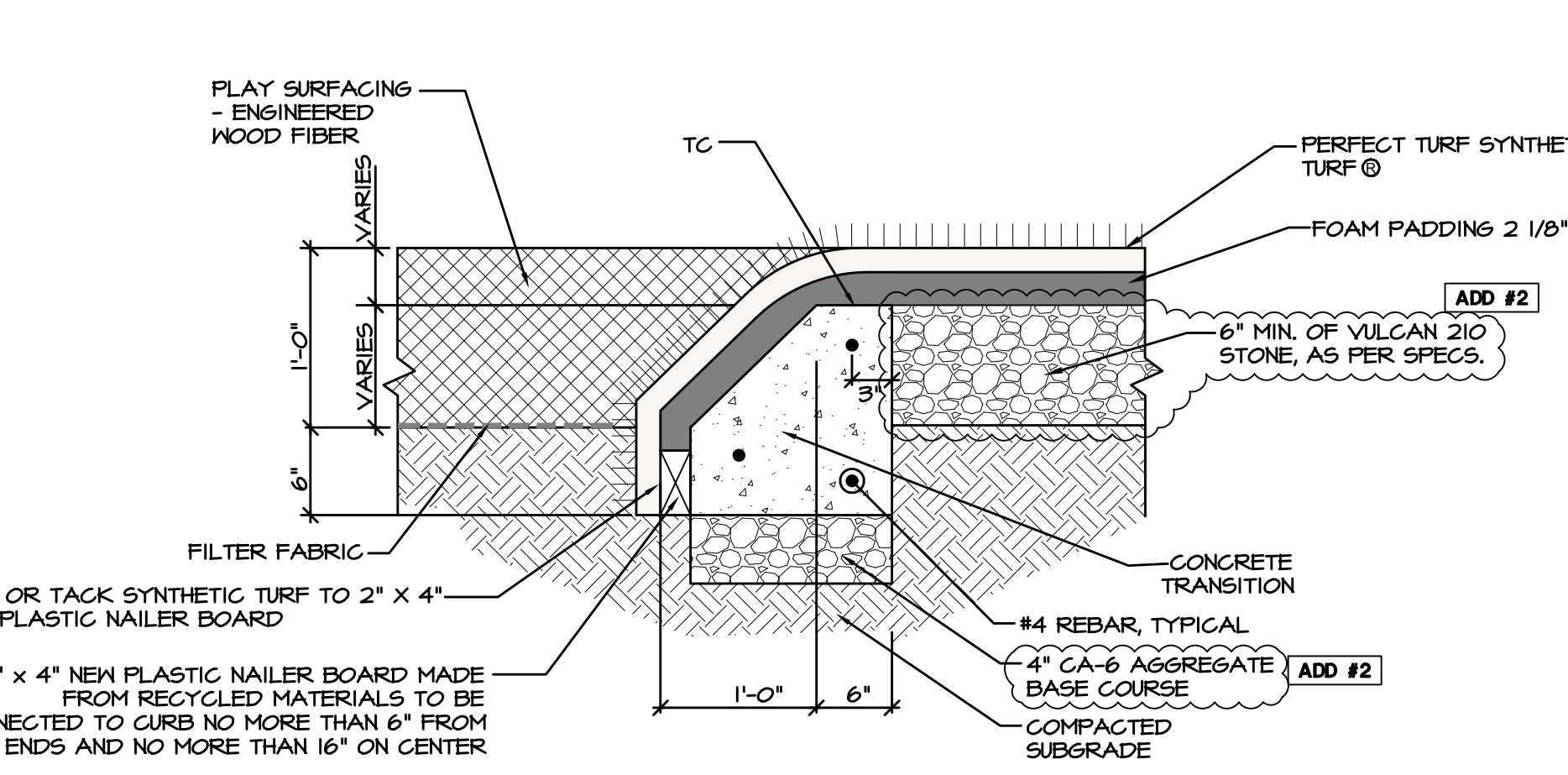

DETAIL - PLAYGROUND TRANSITION CURB
NOT TO SCALE