

| No. | Description | Date |
|-----|-------------------|------------|
| 1 | ISSUED FOR REVIEW | 12/19/2014 |
| 2 | ISSUED FOR BID | 1/20/2015 |

PLAYGROUND IMPROVEMENTS 2015
EVERGREEN PARK
 600 WASHINGTON BLVD.

1685 W. HIGGINS ROAD
 HOFFMAN ESTATES, ILLINOIS 60186
 PHONE: (847) 885-7500
 FAX: (847) 885-7623

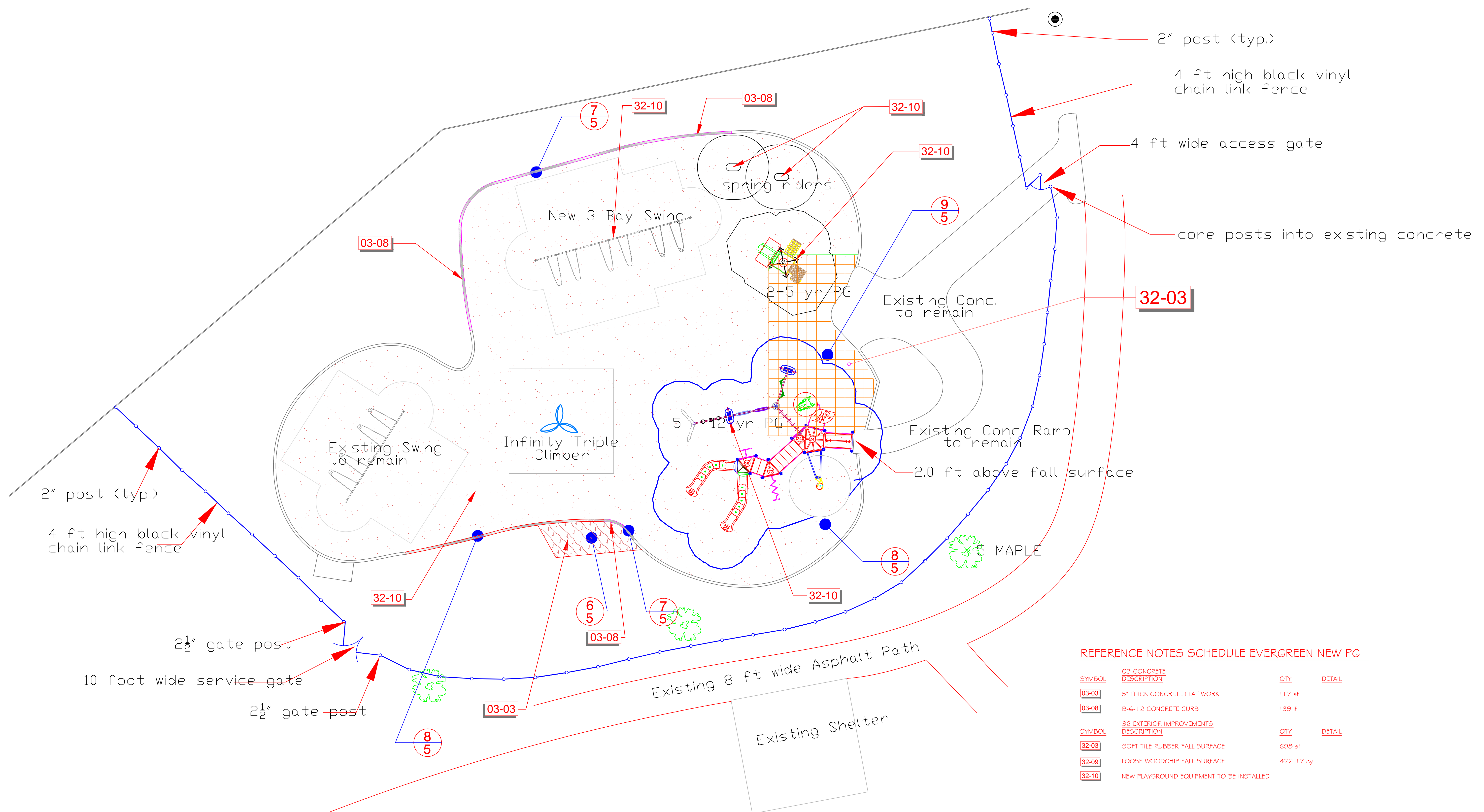

REFERENCE NOTES SCHEDULE EVERGREEN NEW PG

| SYMBOL | 03 CONCRETE DESCRIPTION | QTY | DETAIL |
|--------|--|-----------|--------|
| 03-03 | 5" THICK CONCRETE FLAT WORK | 117 sf | |
| 03-08 | B-6-1.2 CONCRETE CURB | 139 lf | |
| SYMBOL | 32 EXTERIOR IMPROVEMENTS DESCRIPTION | QTY | DETAIL |
| 32-03 | SOFT TILE RUBBER FALL SURFACE | 696 sf | |
| 32-09 | LOOSE WOODCHIP FALL SURFACE | 472.17 cy | |
| 32-10 | NEW PLAYGROUND EQUIPMENT TO BE INSTALLED | | |

EVERGREEN PLAYGROUND NEW
 SCALE 1" = 10 FT

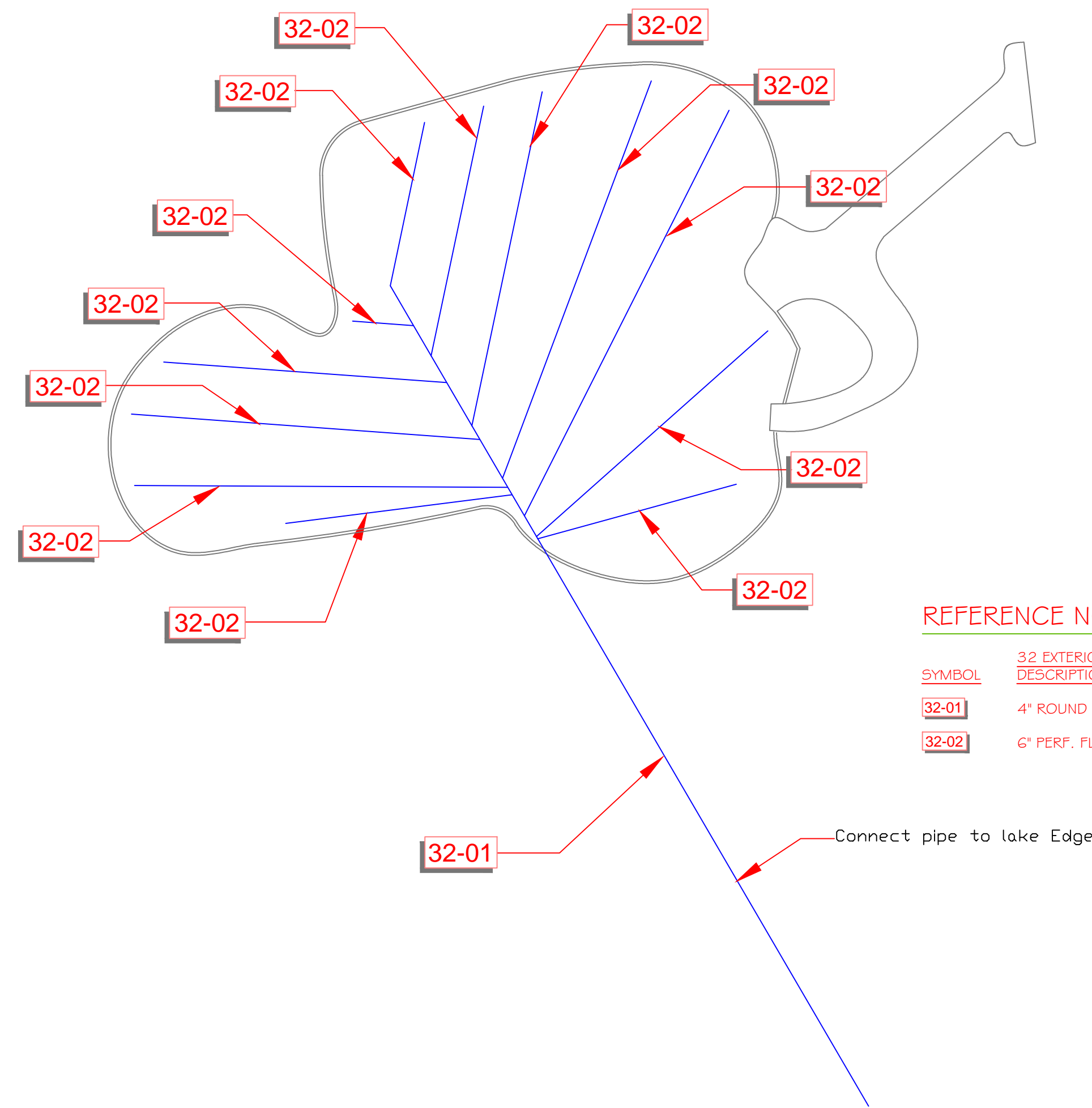

REFERENCE NOTES SCHEDULE EVERGREEN DRAINAGE

| SYMBOL | 32 EXTERIOR IMPROVEMENTS DESCRIPTION | QTY | DETAIL |
|--------|--------------------------------------|--------|--------|
| 32-01 | 4" ROUND PERF. DRAIN TILE | 175 lf | |
| 32-02 | 6" PERF. FLAT PIPE | 633 lf | |

EVERGREEN PLAYGROUND DRAINAGE

SCALE 1" = 20 FT

REFERENCE NOTES SCHEDULE EVERGREEN DEMO

| SYMBOL | DEMOLITION DESCRIPTION | QTY | DETAIL |
|--------|---------------------------------------|--------|--------|
| D-101 | REMOVE EXISTING CONCRETE | | |
| D-102 | SAW CUT EXISTING CURB | | |
| D-105 | REMOVE EXISTING ASPHALT | 155 sf | |
| D-106 | REMOVE EXISTING FALL SURFACE MATERIAL | | |
| D-107 | REMOVE EXISTING PLAYGROUND EQUIPMENT | | |
| D-110 | INSTALL AND MAINTAIN PROTECTION FENCE | | |
| D-112 | REMOVE EXISTING CONCRETE | 33 sf | |
| D-113 | REMOVE EXISTING CURB | 244 lf | |

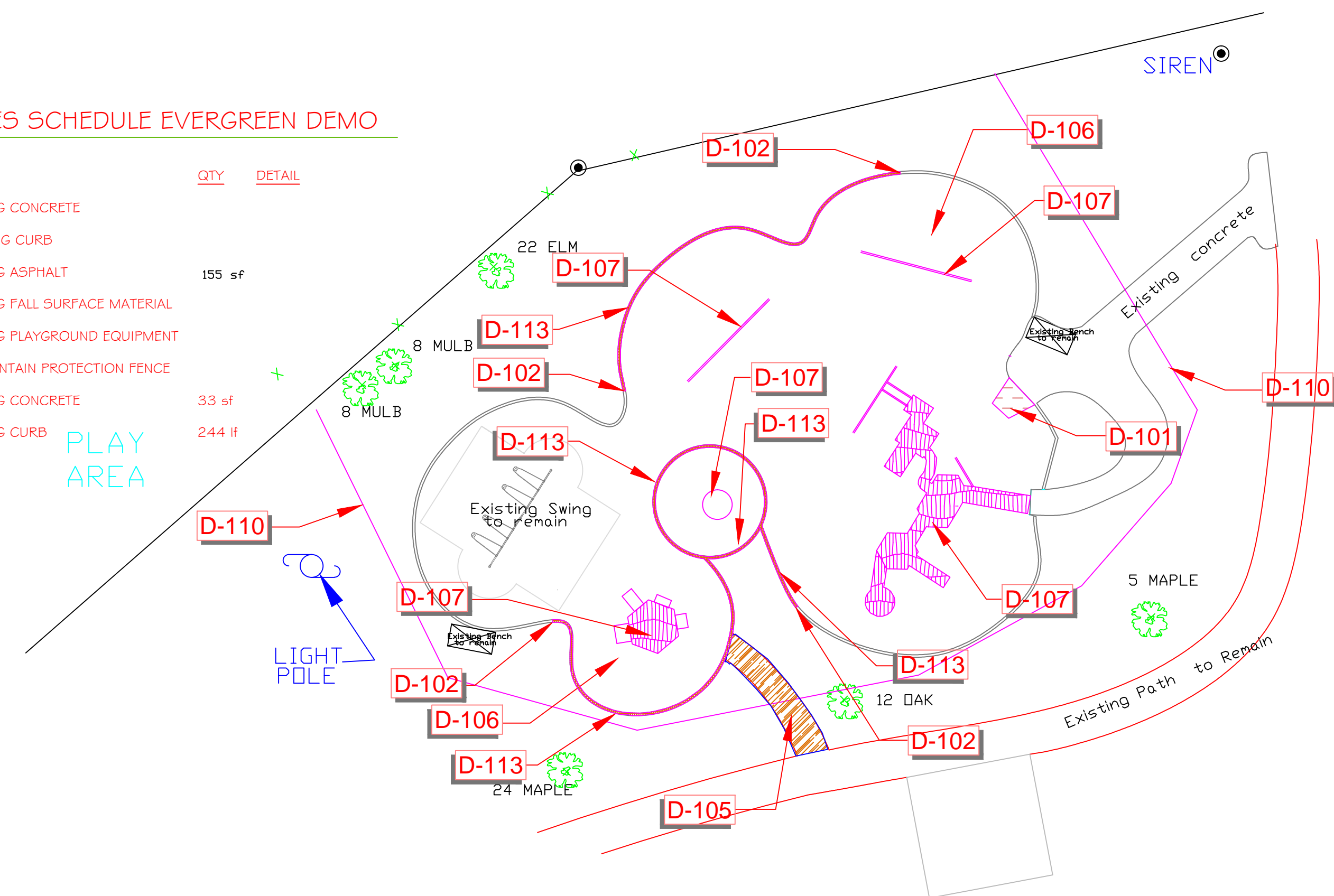

EVERGREEN PLAYGROUND DEMO

SCALE 1" = 20 FT

| No | Description | Date |
|----|-------------------|------------|
| 1 | ISSUED FOR REVIEW | 12/19/2014 |
| 2 | ISSUED FOR BID | 1/20/2015 |

PLAYGROUND IMPROVEMENTS 2015
EVERGREEN PARK
 600 WASHINGTON BLVD.

1685 W. HIGGINS ROAD
 HOFFMAN ESTATES, ILLINOIS 60186
 PHONE: (847) 865-7500
 FAX: (847) 865-7523

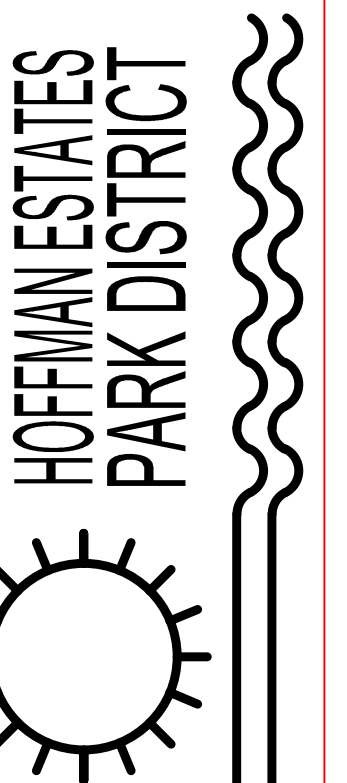

SCALE AS SHOWN'

REFERENCE NOTES SCHEDULE VALLEY DEMO

| SYMBOL | DEMOLITION DESCRIPTION | QTY | DETAIL |
|--------|---------------------------------------|-------|--------|
| D-101 | REMOVE EXISTING CONCRETE | | |
| D-102 | SAW CUT EXISTING CURB | | |
| D-106 | REMOVE EXISTING FALL SURFACE MATERIAL | | |
| D-107 | REMOVE EXISTING PLAYGROUND EQUIPMENT | | |
| D-110 | INSTALL AND MAINTAIN PROTECTION FENCE | 14 LF | |
| D-113 | REMOVE EXISTING CURB | | |
| D-115 | PLAYGROUND EQUIPMENT TO BE RELOCATED | | |

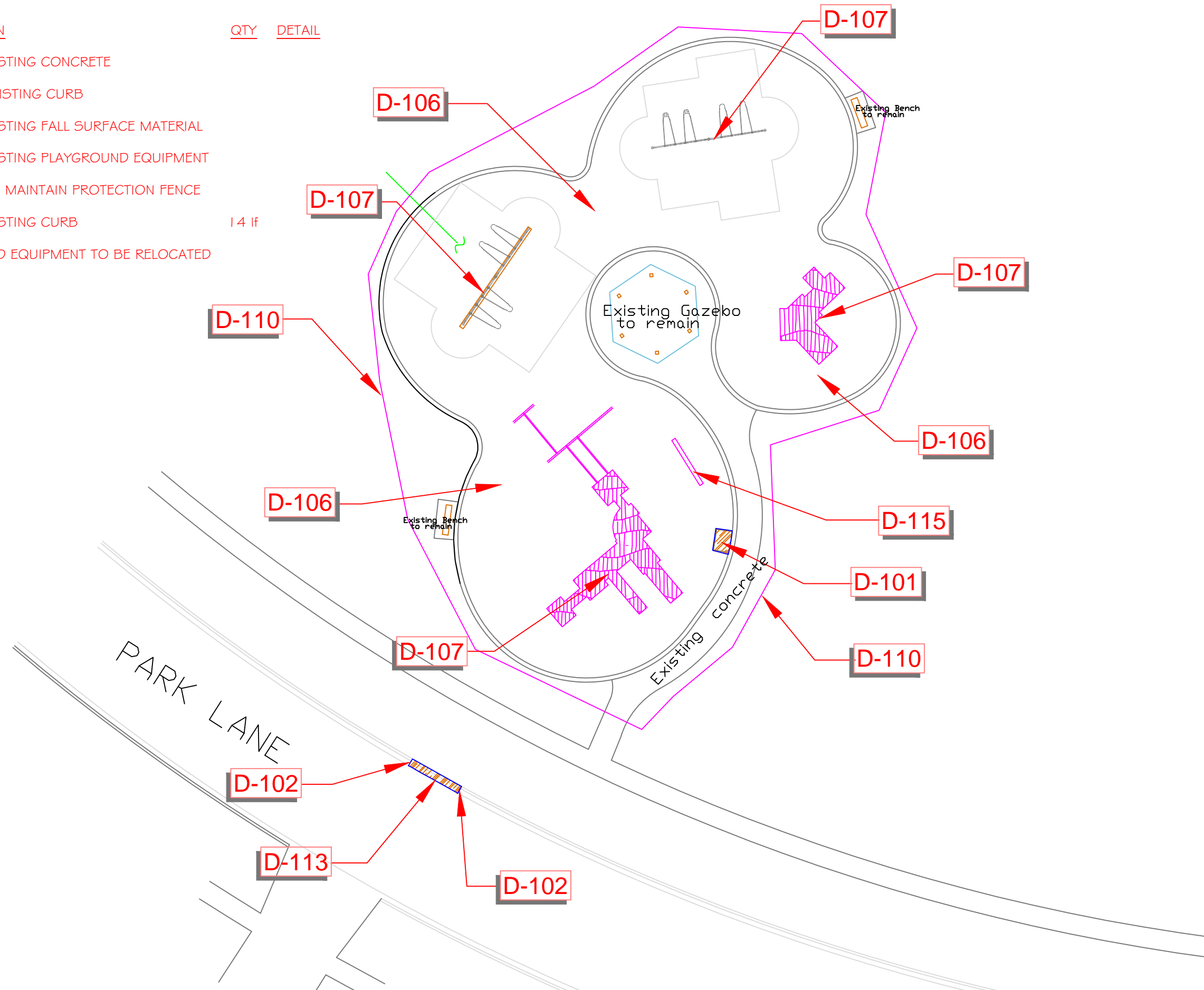

VALLEY PLAYGROUND DEMO

SCALE 1" = 20 FT

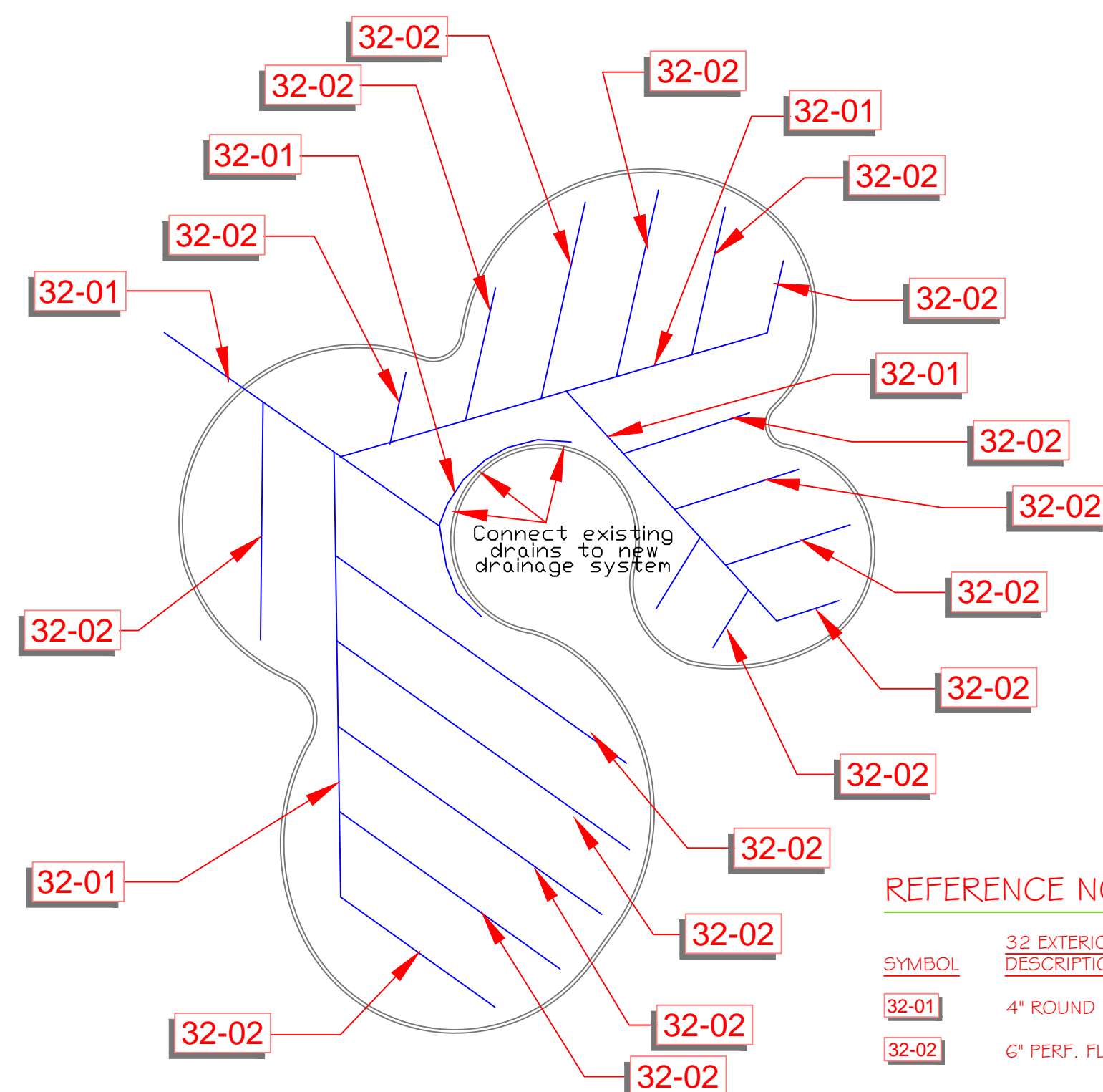

REFERENCE NOTES SCHEDULE VALLEY DRAINAGE

| SYMBOL | 32 EXTERIOR IMPROVEMENTS DESCRIPTION | QTY | DETAIL |
|--------|--------------------------------------|--------|--------|
| 32-01 | 4" ROUND PERF. DRAIN TILE | 264 LF | |
| 32-02 | 6" PERF. FLAT PIPE | 462 LF | |

VALLEY PLAYGROUND DRAINAGE

SCALE 1" = 20 FT

1 90 connectors
21 60 connectors

REFERENCE NOTES SCHEDULE VALLEY NEW PLAYGROUND

| SYMBOL | 03 CONCRETE DESCRIPTION | QTY | DETAIL |
|--------|-----------------------------|--------|--------|
| 03-03 | 5" THICK CONCRETE FLAT WORK | 424 sf | |
| 03-08 | B-G-12 CONCRETE CURB | 11 LF | |

| SYMBOL | 32 EXTERIOR IMPROVEMENTS DESCRIPTION | QTY | DETAIL |
|--------|--------------------------------------|-----------|--------|
| 32-09 | LOOSE WOODCHIP FALL SURFACE | 433.99 cy | |

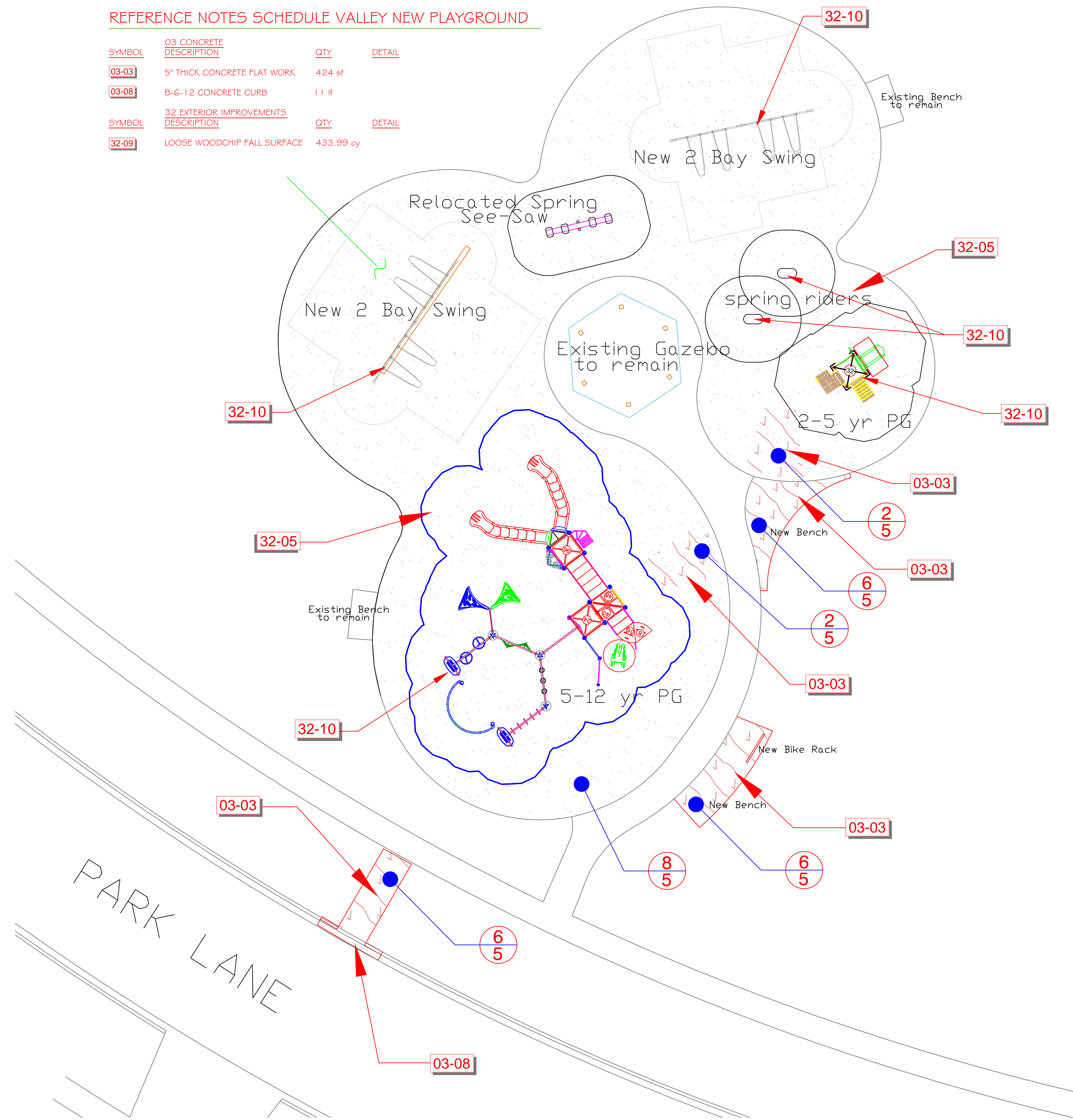

VALLEY PLAYGROUND NEW

SCALE 1" = 10 FT

| No. | Description | Date |
|-----|-------------------|------------|
| 1 | ISSUED FOR REVIEW | 12/19/2014 |
| 2 | ISSUED FOR BID | 1/20/2015 |

PLAYGROUND IMPROVEMENTS 2013
VALLEY PARK
850 PARK LANE

1685 W. HIGGINS ROAD
HOFFMAN ESTATES, ILLINOIS 60195
PHONE: (847)-885-7500
FAX: (847)885-7523

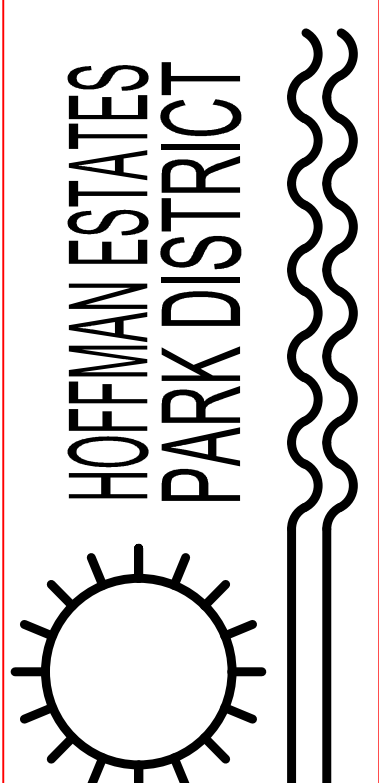

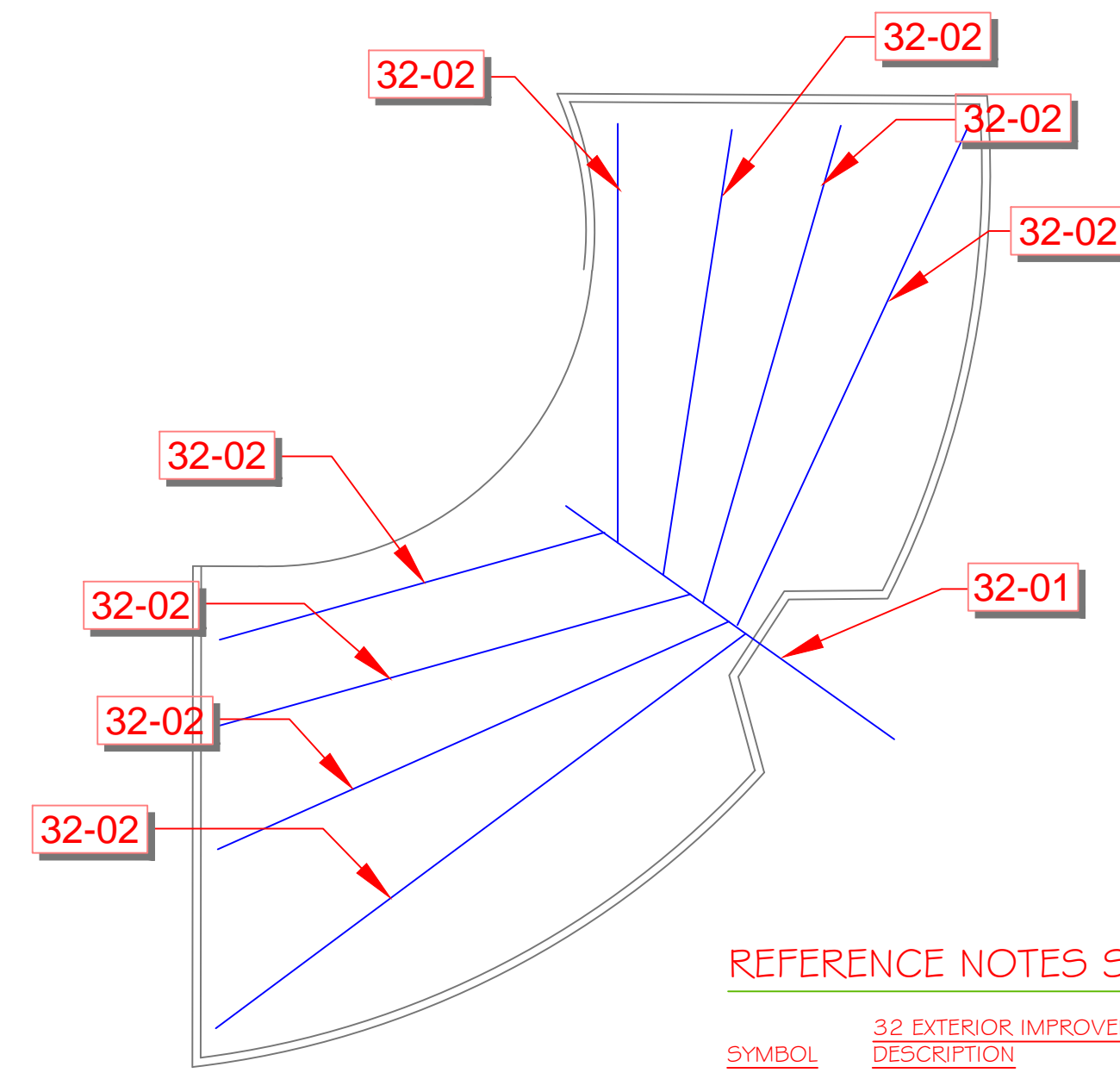

REFERENCE NOTES SCHEDULE MAPLE DRAINAGE

| SYMBOL | 32 EXTERIOR IMPROVEMENTS DESCRIPTION | QTY | DETAIL |
|--------|--------------------------------------|--------|--------|
| 32-01 | 4" ROUND PERF. DRAIN TILE | 49 lf | |
| 32-02 | 6" PERF. FLAT PIPE | 486 lf | |

MAPLE PLAYGROUND DRAINAGE

SCALE 1" = 20 FT

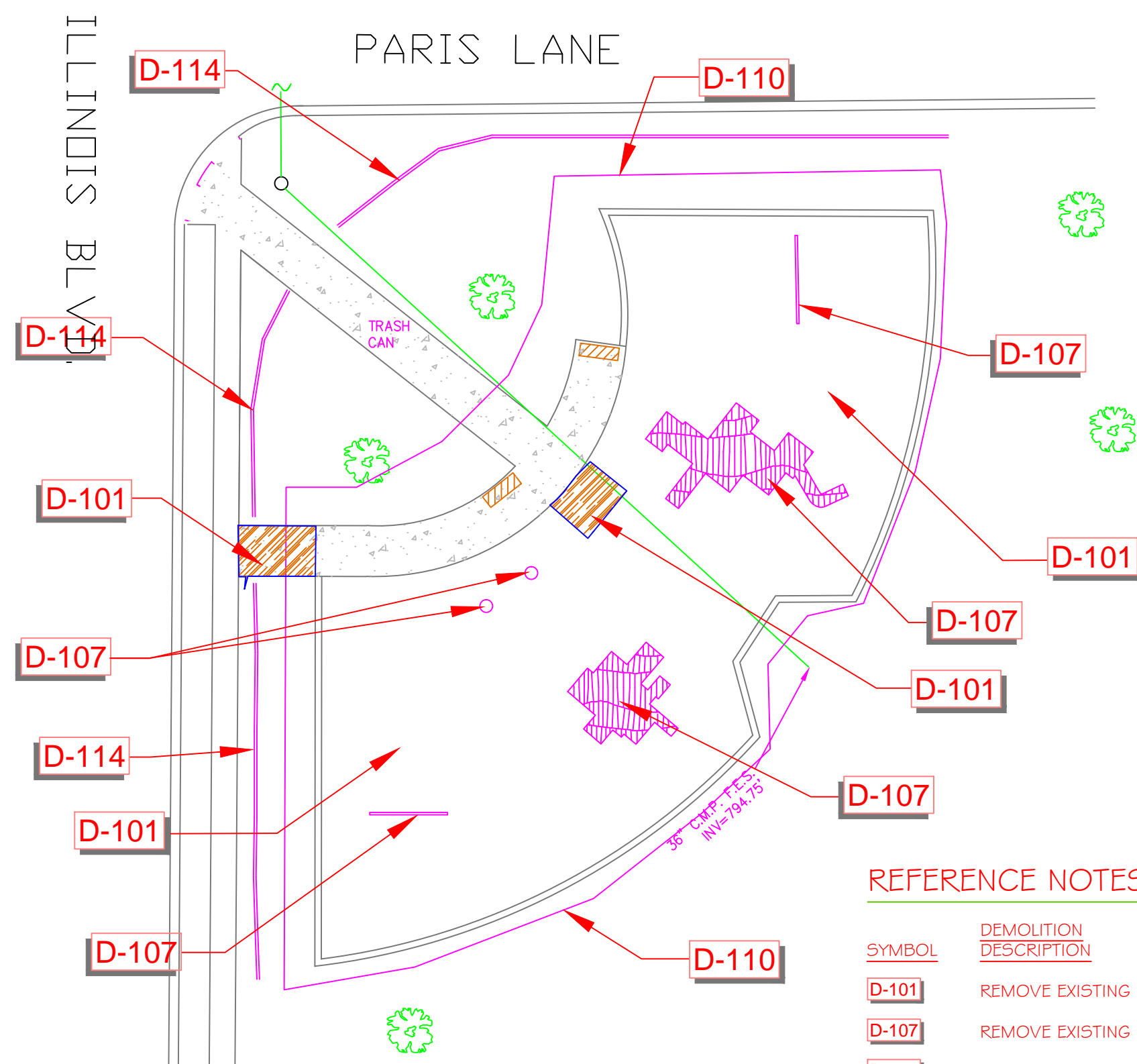

REFERENCE NOTES SCHEDULE MAPLE DEMO

| SYMBOL | DEMOLITION DESCRIPTION | QTY | DETAIL |
|--------|---------------------------------------|-----|--------|
| D-101 | REMOVE EXISTING CONCRETE | | |
| D-107 | REMOVE EXISTING PLAYGROUND EQUIPMENT | | |
| D-110 | INSTALL AND MAINTAIN PROTECTION FENCE | | |
| D-114 | REMOVE EXISTING SPLIT RAIL FENCE | | |

MAPLE PLAYGROUND DEMO

SCALE 1" = 20 FT

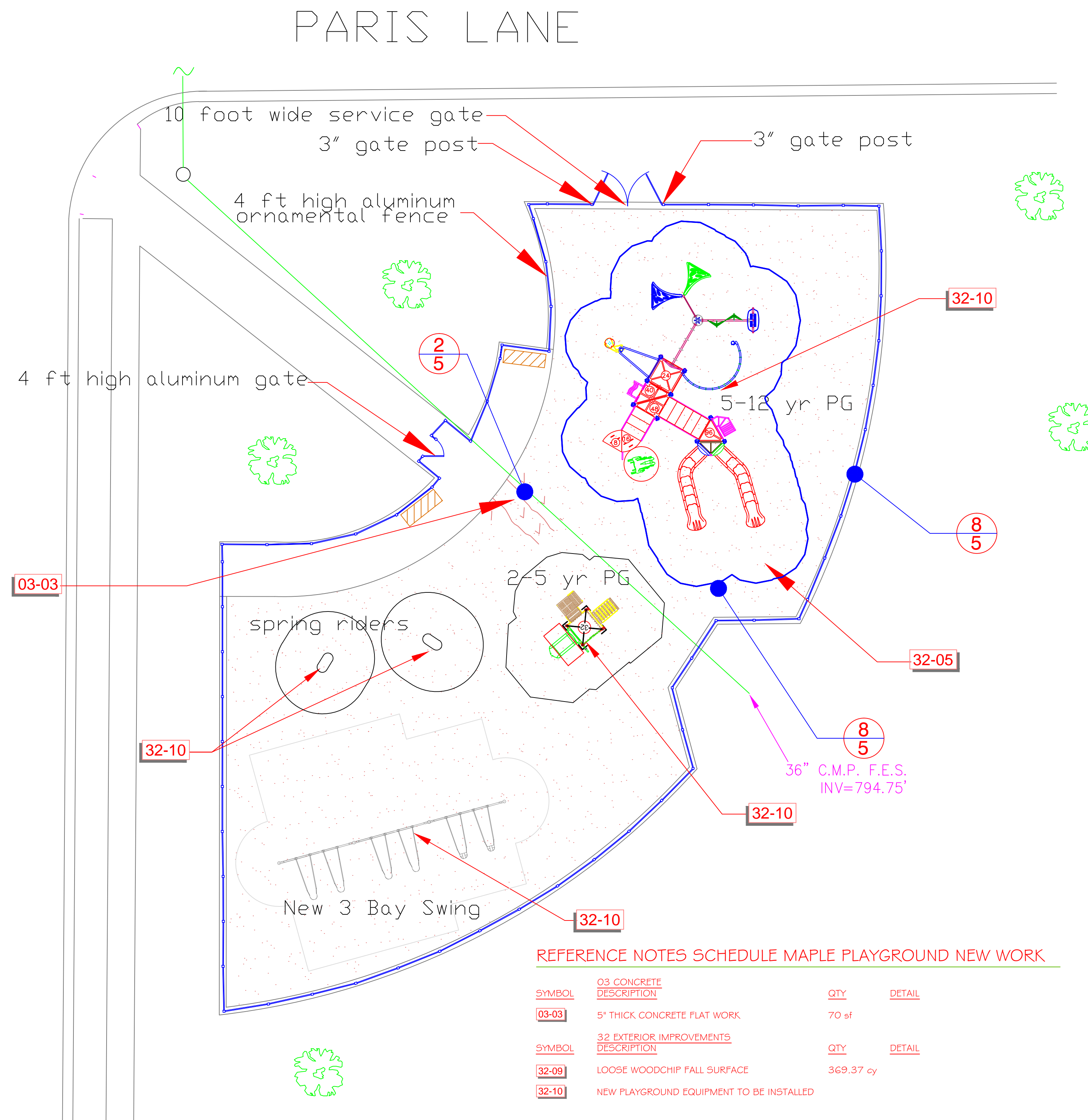

REFERENCE NOTES SCHEDULE MAPLE PLAYGROUND NEW WORK

| SYMBOL | 03 CONCRETE DESCRIPTION | QTY | DETAIL |
|--------|-----------------------------|-------|--------|
| 03-03 | 5" THICK CONCRETE FLAT WORK | 70 sf | |

| SYMBOL | 32 EXTERIOR IMPROVEMENTS DESCRIPTION | QTY | DETAIL |
|--------|--|-----------|--------|
| 32-09 | LOOSE WOODCHIP FALL SURFACE | 369.37 cy | |
| 32-10 | NEW PLAYGROUND EQUIPMENT TO BE INSTALLED | | |

MAPLE PLAYGROUND NEW

SCALE 1" = 10 FT

| No. | Description | Date |
|-----|-------------------|------------|
| 1 | ISSUED FOR REVIEW | 12/19/2014 |
| 2 | ISSUED FOR BID | 1/20/2015 |

PLAYGROUND IMPROVEMENTS 2013
 MAOLE PARK
 105 ILLINOIS BLVD.

1685 W. HIGGINS ROAD
 HOFFMAN ESTATES, ILLINOIS 60185
 PHONE: (847) 888-7500
 FAX: (847) 888-7523

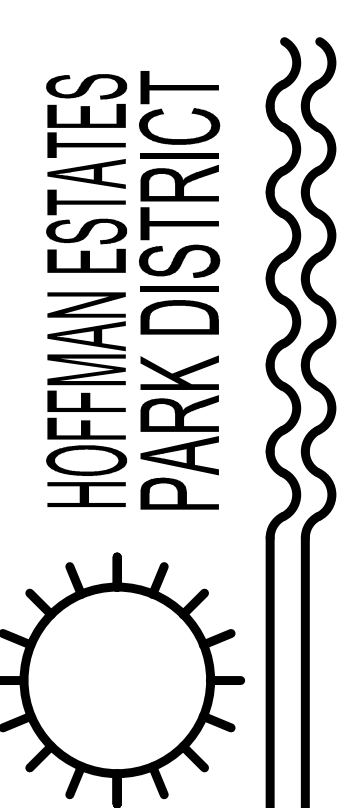

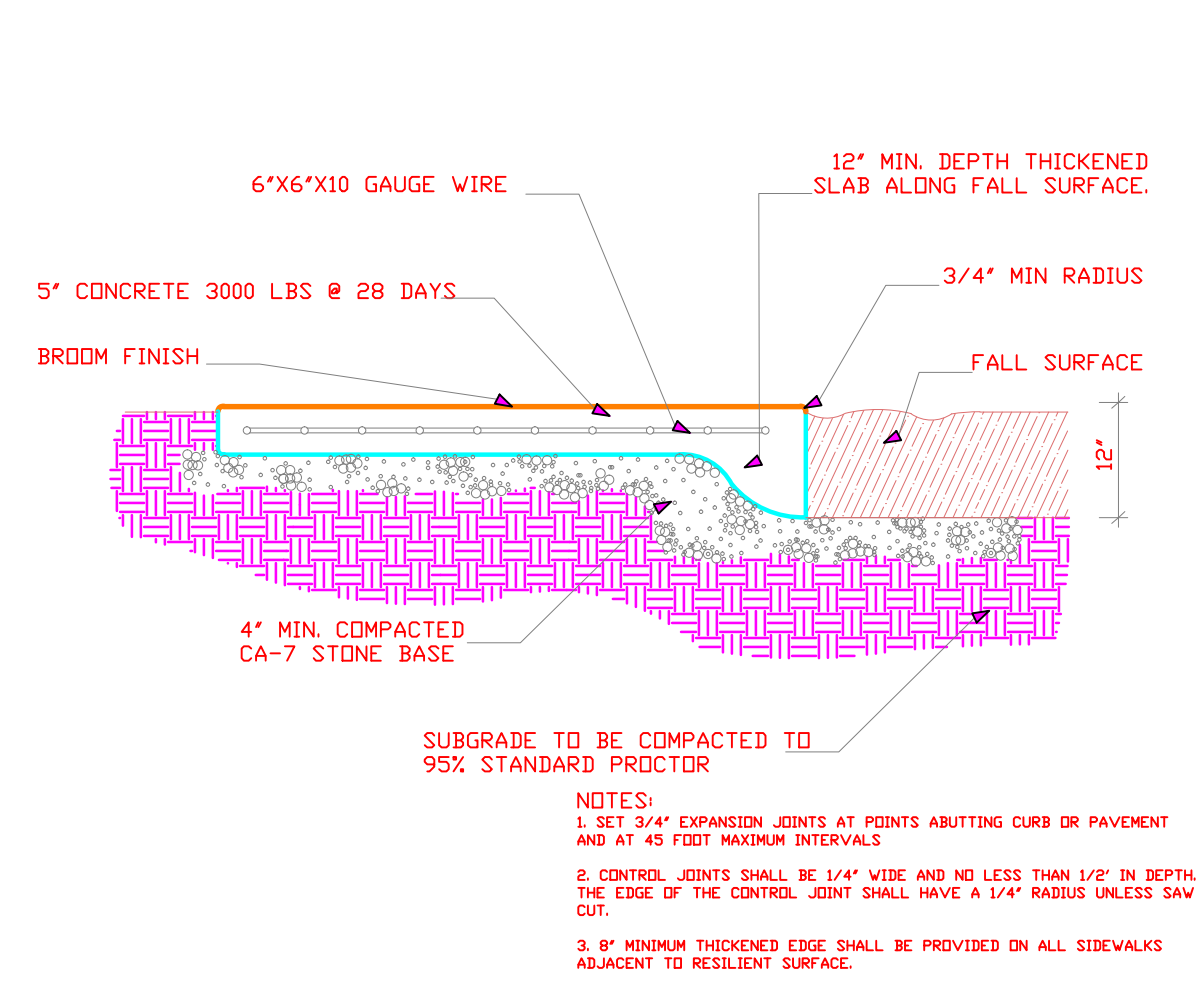

1
5 **SIDEWALK DETAIL AT PLAYGROUND**
No Scale

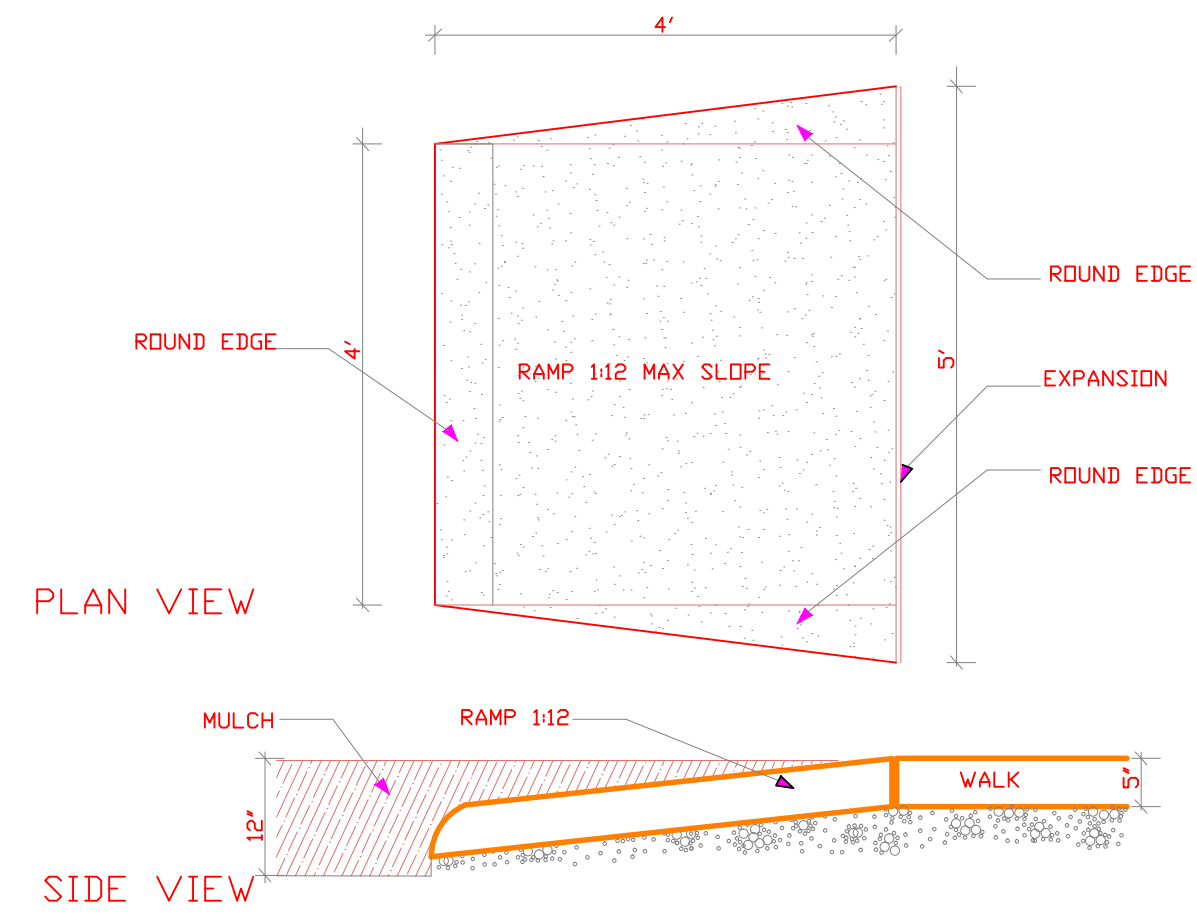

2
5 **RAMP INTO PLAYGROUND DETAIL**
No Scale

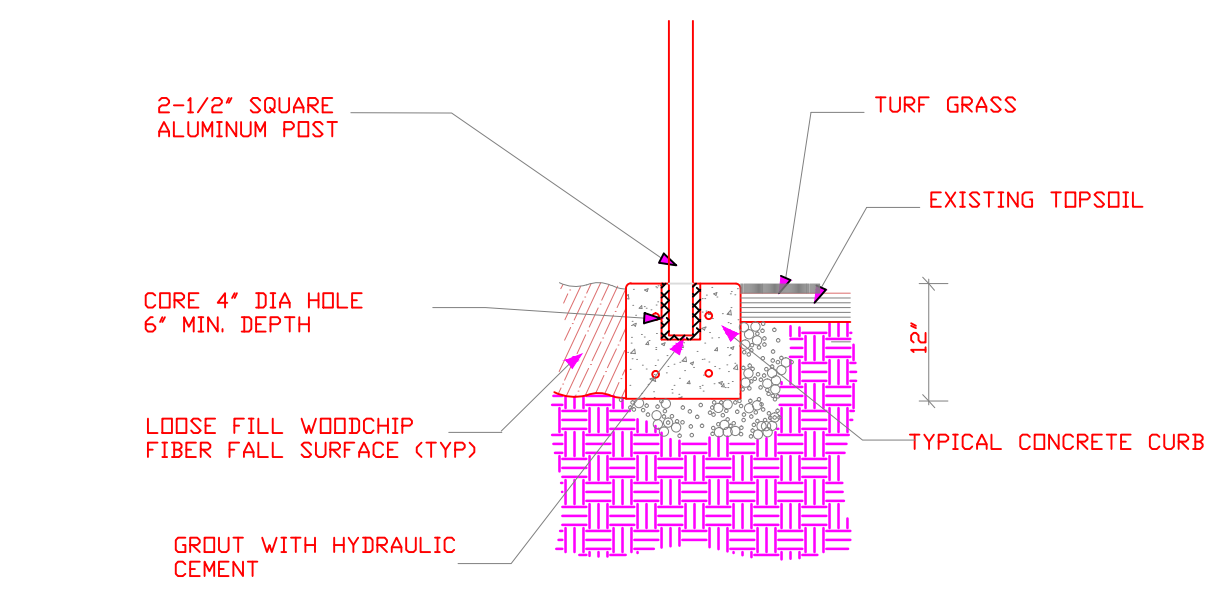

3
5 **ORNAMENTAL FENCE POST IN CONCRETE DETAIL**
No Scale

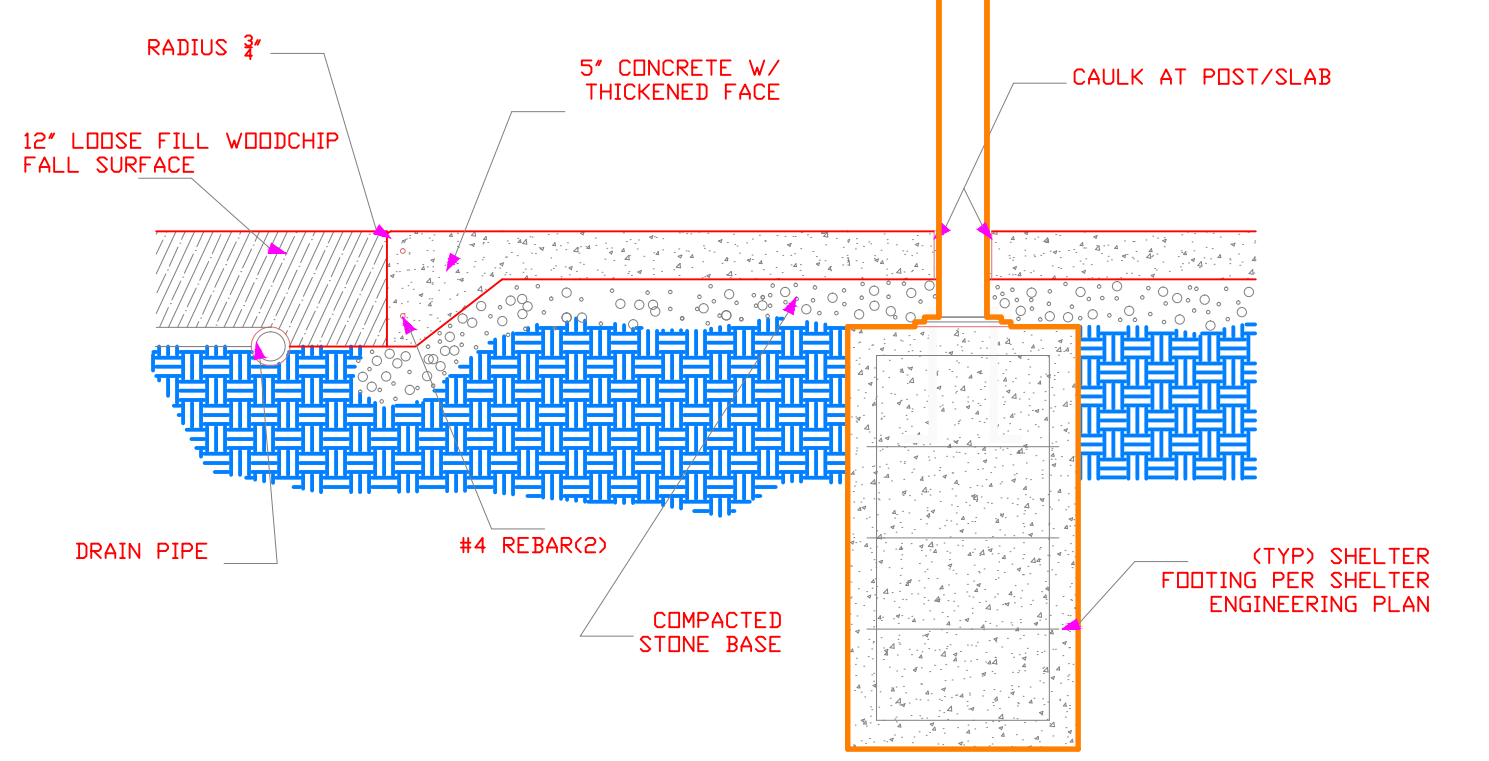

4
5 **SHADE STRUCTURE COLUMN INTO SLAB DETAIL**
No Scale

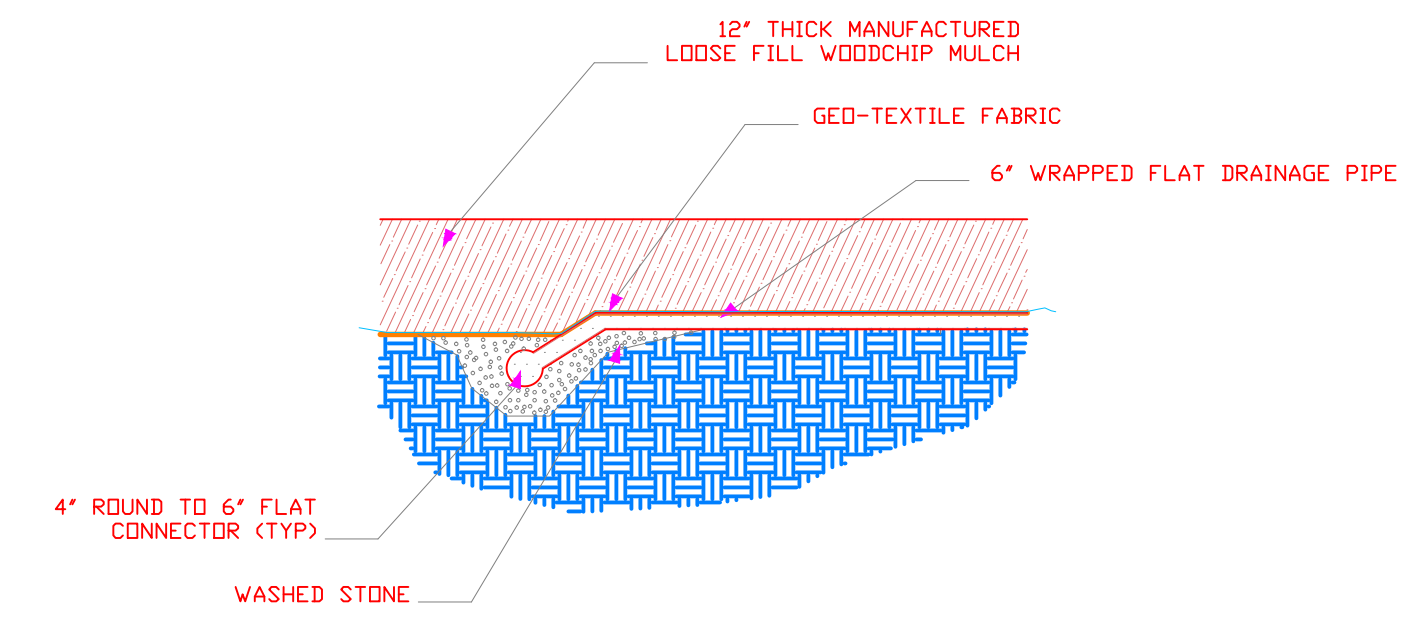

5
5 **TYPICAL PLAYGROUND DRAINAGE DETAIL**
No Scale

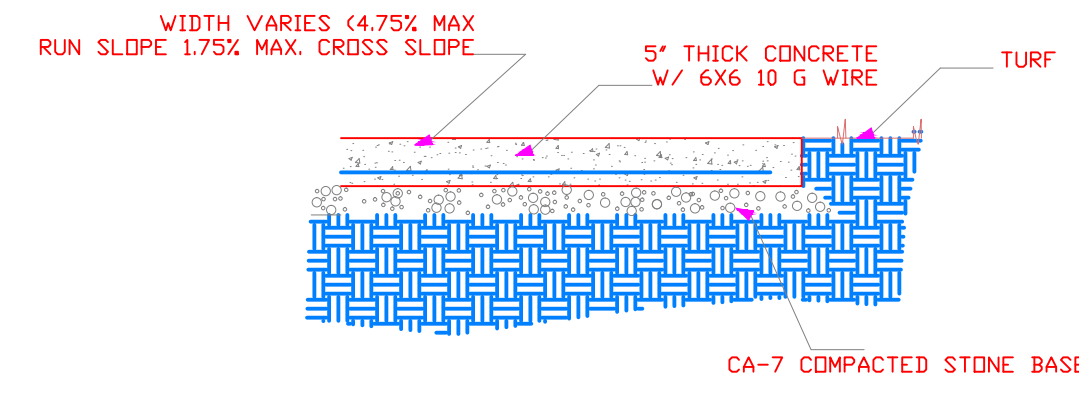

6
5 **TYPICAL CONCRETE SLAB DETAIL**
No Scale

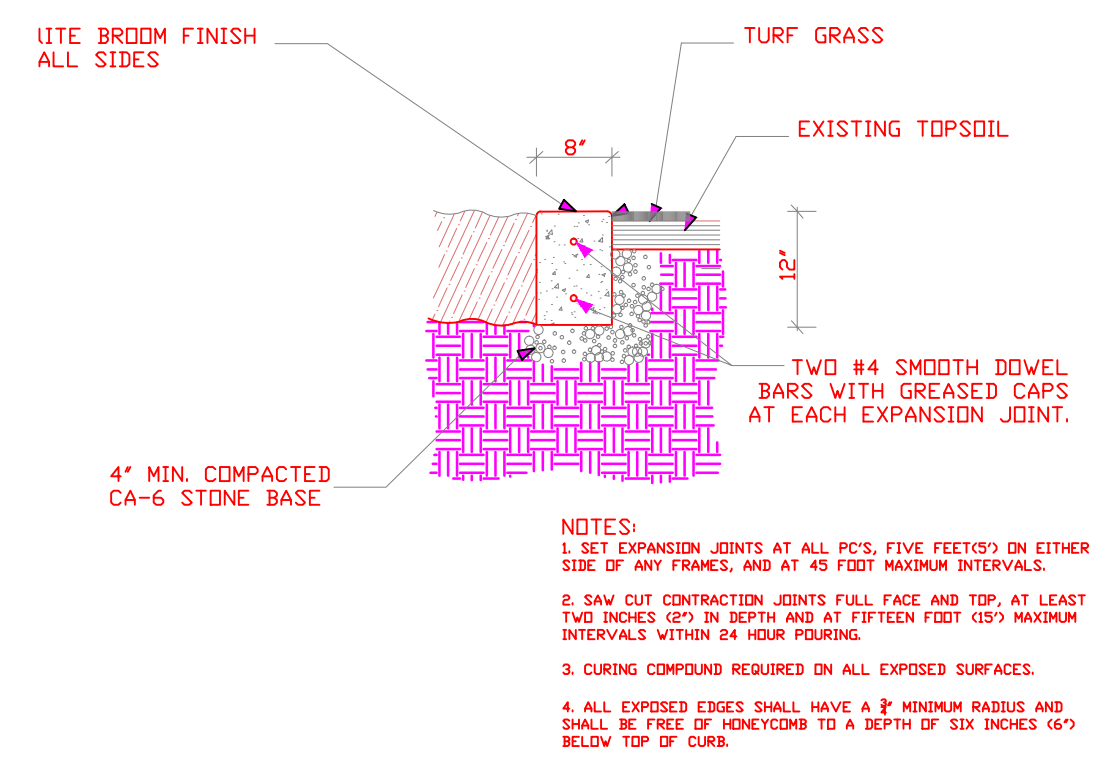

7
5 **8" x 12" CONCRETE CURB DETAIL**
No Scale

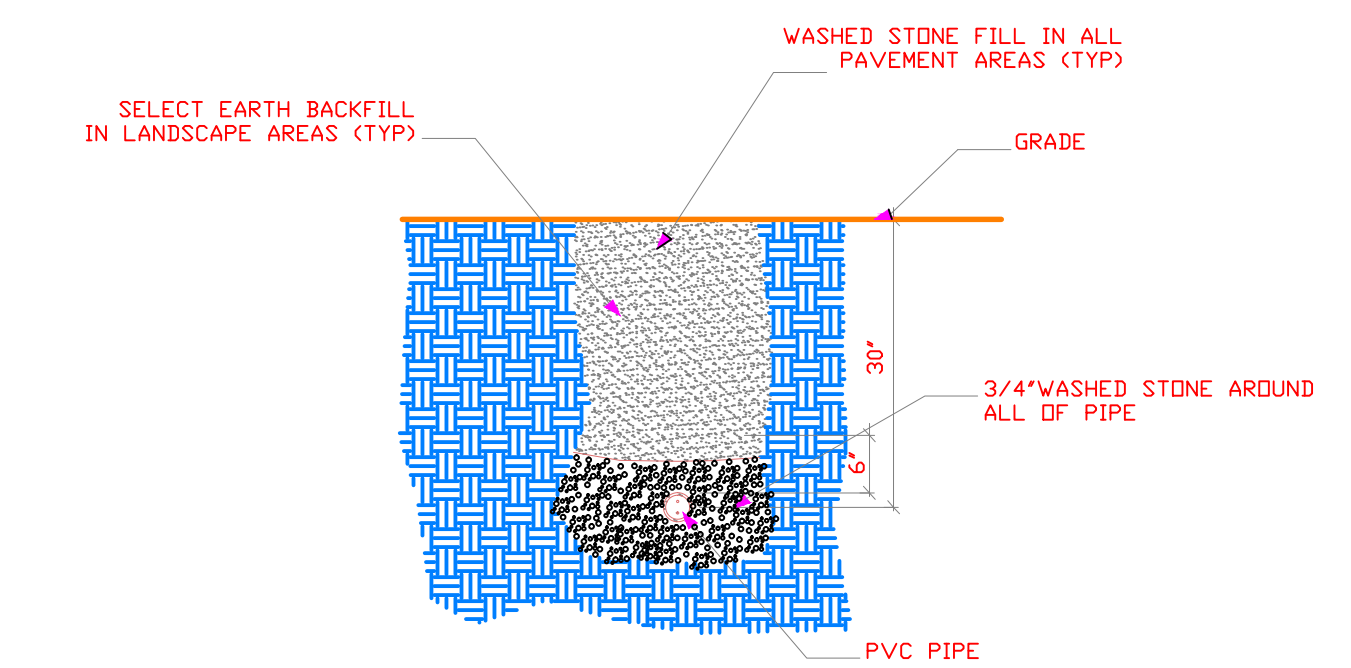

8
5 **TYPICAL TRENCH DETAIL**
No Scale

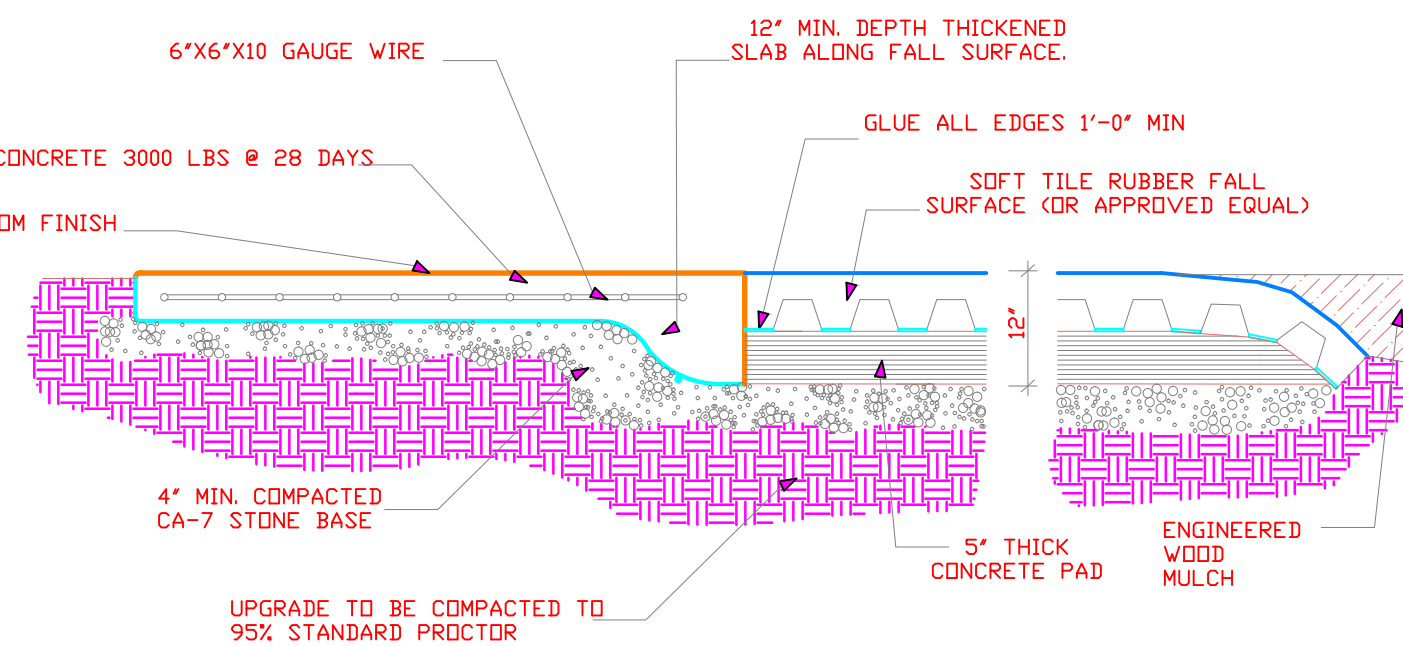

9
5 **SOFTTILE FALL SURFACE DETAIL**
No Scale

| No | Description | Date |
|----|-------------------|------------|
| 1 | ISSUED FOR REVIEW | 12/19/2014 |
| 2 | ISSUED FOR BID | 1/20/2015 |

PLAYGROUND IMPROVEMENTS 2014
DETAILS
EVERGREEN - MAPLE - VALLEY PARKS

1685 W. HIGGINS ROAD
HOFFMAN ESTATES, ILLINOIS 60119
PHONE: (847)-885-7500
FAX: (847)885-7523

